

Adult Changing Table Installation General Scope

Tennessee Department of Transportation is seeking bids for provision and installation of adult changing tables in each of the listed rest areas and welcome centers. The work will include relocation of existing bathroom fixtures and associated plumbing as outlined in the attached specification documents. Each location may be awarded separately. A General Contractors License is required. A general contractor shall oversee all work.

Definitions:

ADA – Americans with Disabilities Act

TDOT – Tennessee Department of Transportation

MPE – Multi Phase Extraction

U.N.O – Unless Noted Otherwise

RR – Rest Room

Locations:

1. Shelby County Welcome Center located on I-55 north bound at mile marker 3.1, Memphis, TN, 38116
2. Marion County Rest Area located on I-24 east bound at mile marker 160 Jasper TN, 37347
3. Unicoi Welcome Center located on I-75 south bound at mile marker 161, Fiddlers Lane, TN 373650
4. Hamilton County Welcome Center located on I-24 east bound at mile marker 171.8, Tiftonia, TN 37419
5. Giles County Welcome Center located on I-65 north bound at mile marker 3.1, Ardmore, TN, 38449
6. Campbell County Welcome Center located on I-75 south bound at mile marker 161, 481 Holiday Lane, Jellico, TN 37762
7. Sullivan County Welcome Center located on I-26 south bound at mile marker 5, Kingsport, TN, 37664

Site Visit Scheduling:

Leo Hagewood at George.Hagewood@tn.gov or 615-806-3045

- Shelby County Welcome Center
- Giles County Welcome Center

Tim Worley at Timothy.Worley@tn.gov or 423-208-7440

- Marion County Rest Area
- Unicoi County Welcome Center
- Hamilton County Welcome Center
- Campbell County Welcome Center
- Sullivan County Welcome Center

Electric Powered Adult Wall Mounted Changing Table specifications:

- Working Load: minimum 440 pounds
- Total maximum width shall not exceed 41" from wall when table/stretchers is deployed
- Table/stretchers dimensions: Length: minimum 70" – maximum 72"
Width: minimum 30" – maximum 32"
- Table/stretchers surface to be designed for easy clean-up.
- Adjustable height range of 12" from floor to 39" from floor
- Table/stretchers to manually fold up when not in use.
- Fold down safety rail on front of table/stretchers.
- Integrated front control panel for raising and lowering table/stretchers.
- Electrical requirement: 120 volt

Acceptable Brands/Models: Astor Bannerman Invincible, Pressalit CT4000 VersaMax, or Equal*

*If bidding an equal brand please submit literature that substantiates the item bid meets specifications.



George Leo Hagewood
Facilities Manager 3
Maintenance Operations Division
James K. Polk Bldg., Suite 400
505 Deaderick St. Nashville, TN. 37243
C:615-806-3045

Timothy Worley, Transportation Manager 1
Maintenance Operations Division
James K Polk Building, Suite 400
505 Deaderick Street, Nashville TN 37243
C: 423-208-7440

I-55 SHELBY COUNTY WELCOME CENTER



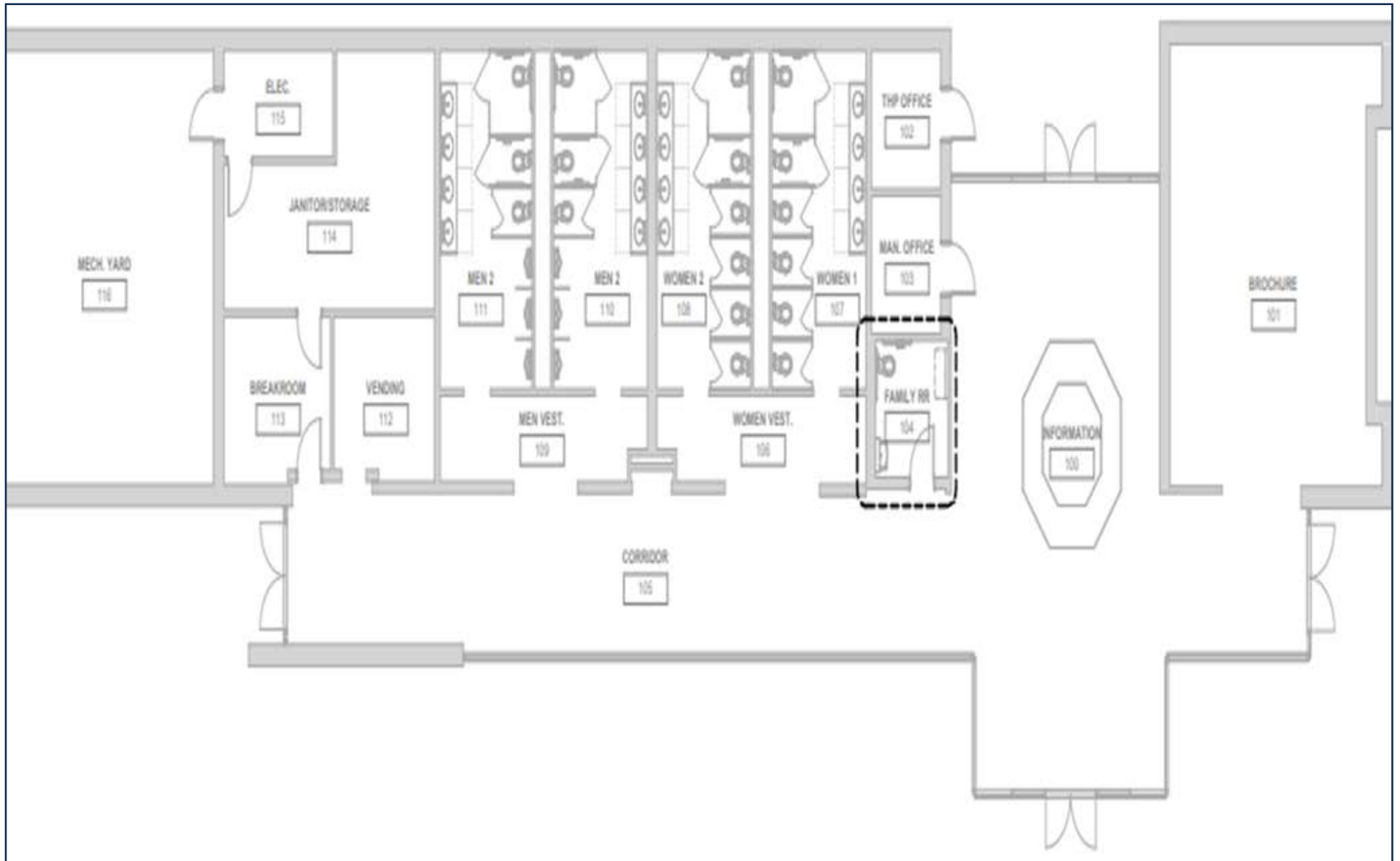

EXISTING FLOOR PLAN

KEYNOTES

1 REMOVE BABY CHANGING STATION

2 REMOVE RUBBER DOORSTOP

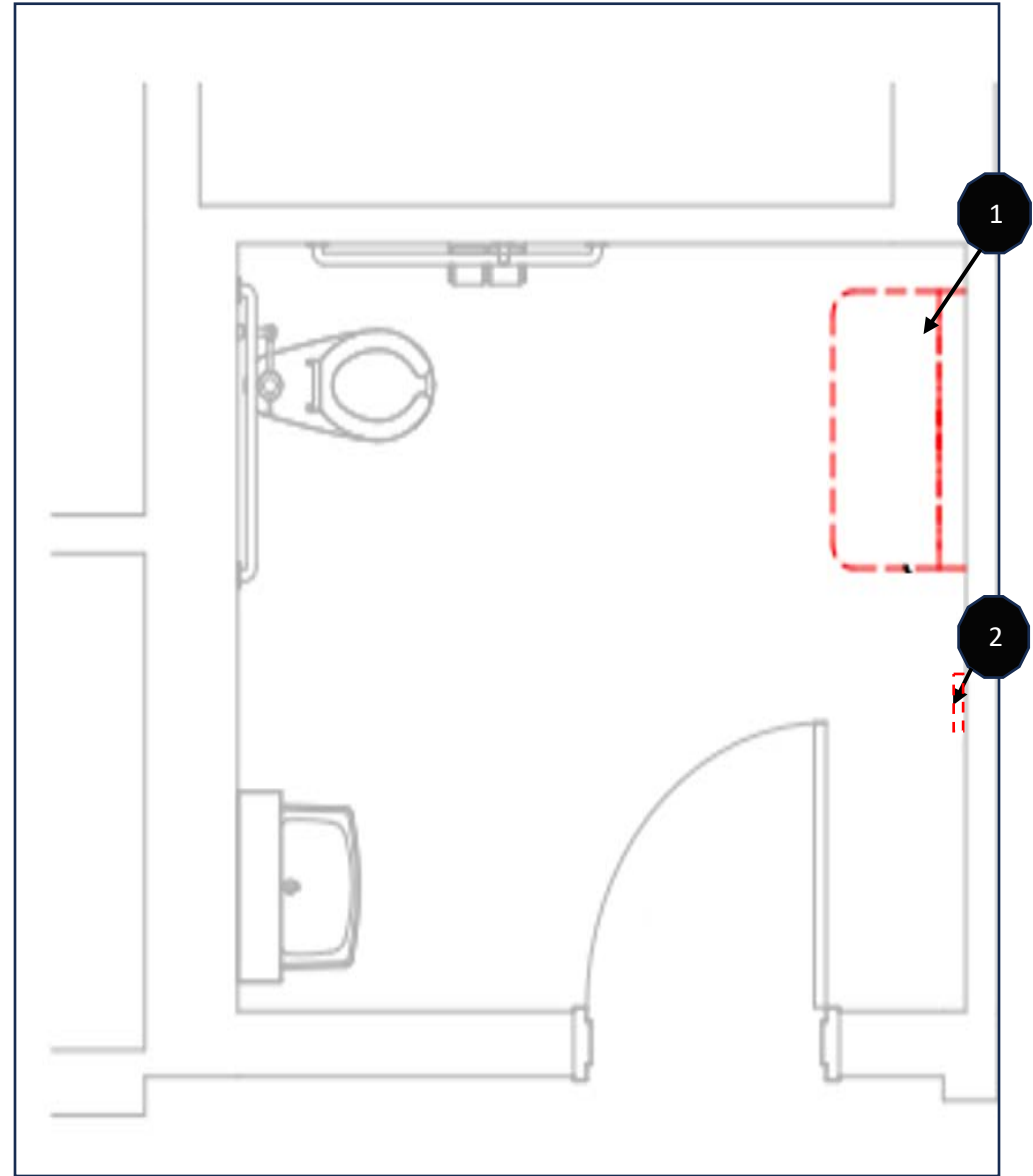

ENLARGED DEMO PLANS/PHOTO

REMOVAL OF:

- **BABY CHANGING STATION AS INDICATED IN KEYNOTE 1. THIS INCLUDES:**
 - **COLOR FILL ANY EXISTING HOLES ~~FILL~~ DUE TO REMOVAL OF CHANGING STATION**
 - **BABY CHANGING STATION TO BE GIVEN TO OWNER**
- **RUBBER DOORSTOP AS INDICATED IN KEYNOTE 2. THIS INCLUDES:**
 - **COLOR FILL ANY EXISTING HOLES DUE TO REMOVAL**

NOTE:

- **TAKE CARE TO PROTECT EXISTING TILE DURING DEMO. ANY DAMAGE TO TILE/GROUT OR ANY OTHER PORTIONS OF THE WALL OR FLOOR SHALL BE REPAIRED AT THE EXPENSE OF THE CONTRACTOR.**
- **CONTRACTOR WILL BE RESPONSIBLE FOR REMOVING ALL DEBRIS OFF SITE.**

KEYNOTE

1 INSTALL ACCEPTABLE BRANDS/MODEL CHANGING TABLE

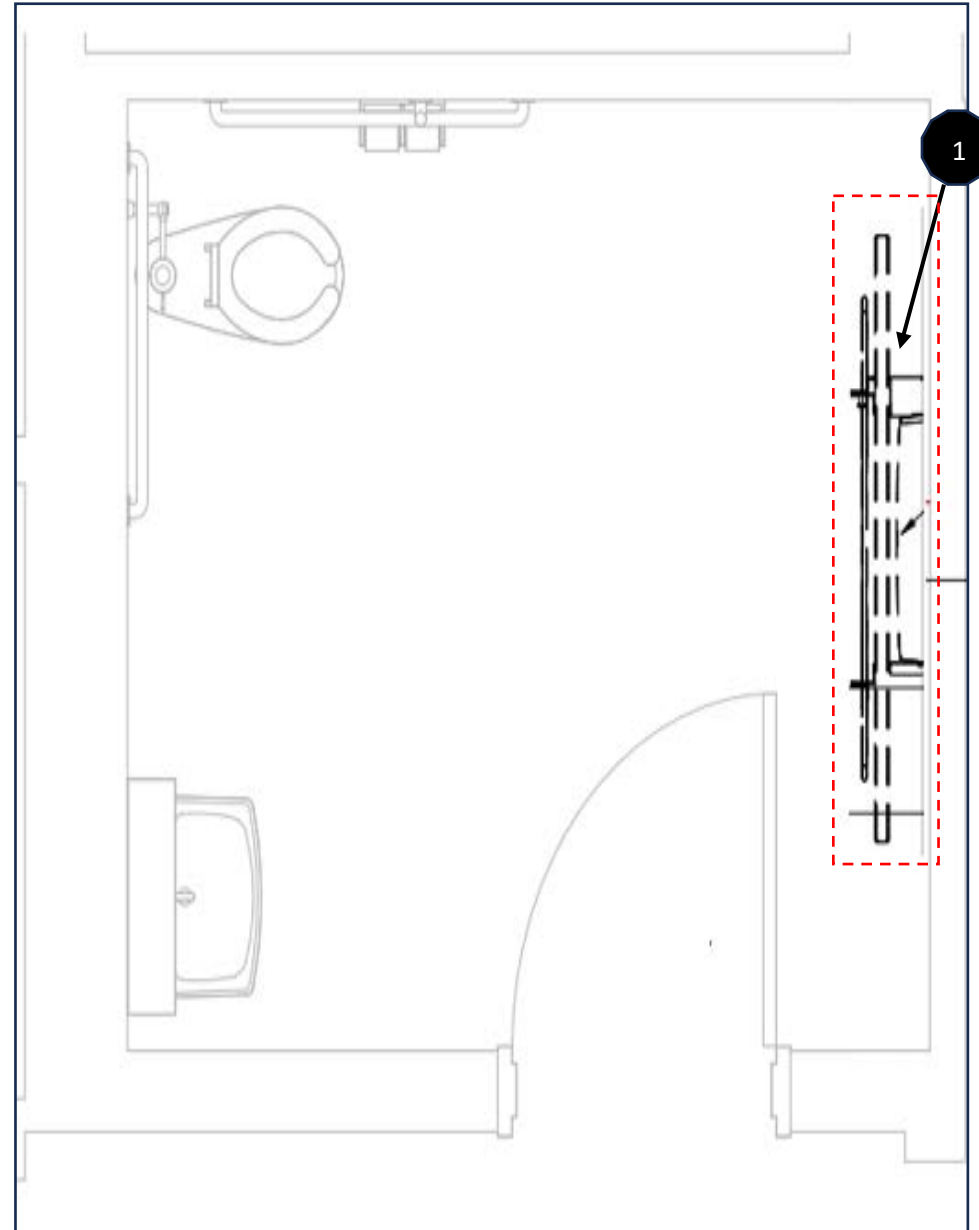
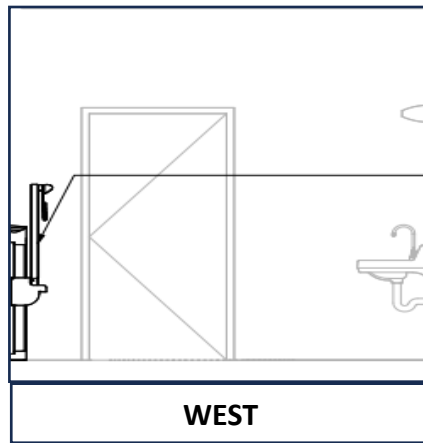
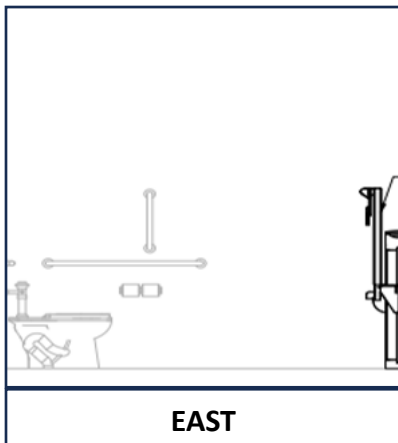
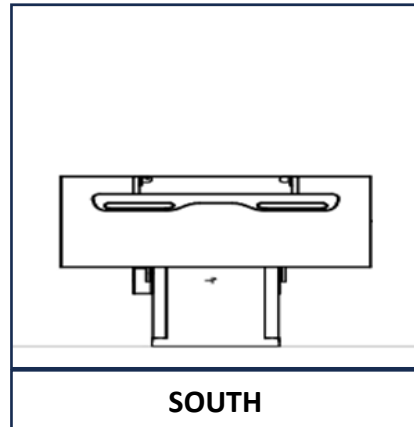
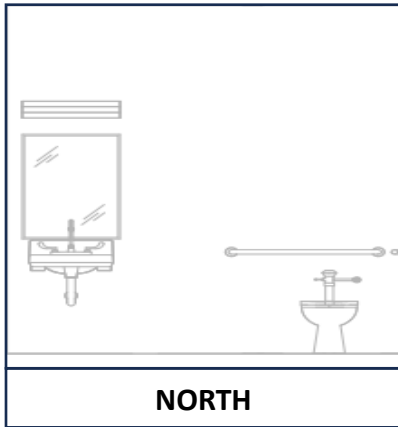

INSTALL LAYOUT

INSTALLATION OF:

- **ACCEPTABLE BRANDS/MODELS: ASTOR BANNERMAN INVINCIBLE, PRESSALIT CT4000 VERSAMAX, OR EQUAL* AS INDICATED IN KEYNOTE**
 1. **THIS INCLUDES:**
 - **REVIEWING THE INSTALLATION MANUAL FOR REQUIRED FASTENERS TO SUPPORT THE 440 LBS.**
 - **ANY ADDITIONAL WALL/STUD SUPPORT FOR MOUNTING.**
 - **INSTALL CHANGING TABLE TEN INCHES FROM THE WALL TO AVOID HANDICAP ASSIST RAIL.**

- **POWER SOURCE. THIS INCLUDES:**
 - **CLOSEST OUTLET SHALL BE LOCATED ON THE SITE AND POWER PULLED TO THE TABLE.**

NOTE:

- **ANY DAMAGES DURING INSTALLATION SHALL BE REPAIRED AT THE EXPENSE OF THE CONTRACTOR**
- **POINT OF CONTACT SHALL BE NOTIFIED SHOULD ANY ADDITIONAL CHANGES ARE NEEDED OUTSIDE THE SCOPE OF WORK.**
- **CONTRACTOR SHALL BE RESPONSIBLE FOR SUPPLYING ALL HARDWARE NEEDED FOR INSTALL.**

SCOPE OF WORK/INSTALL



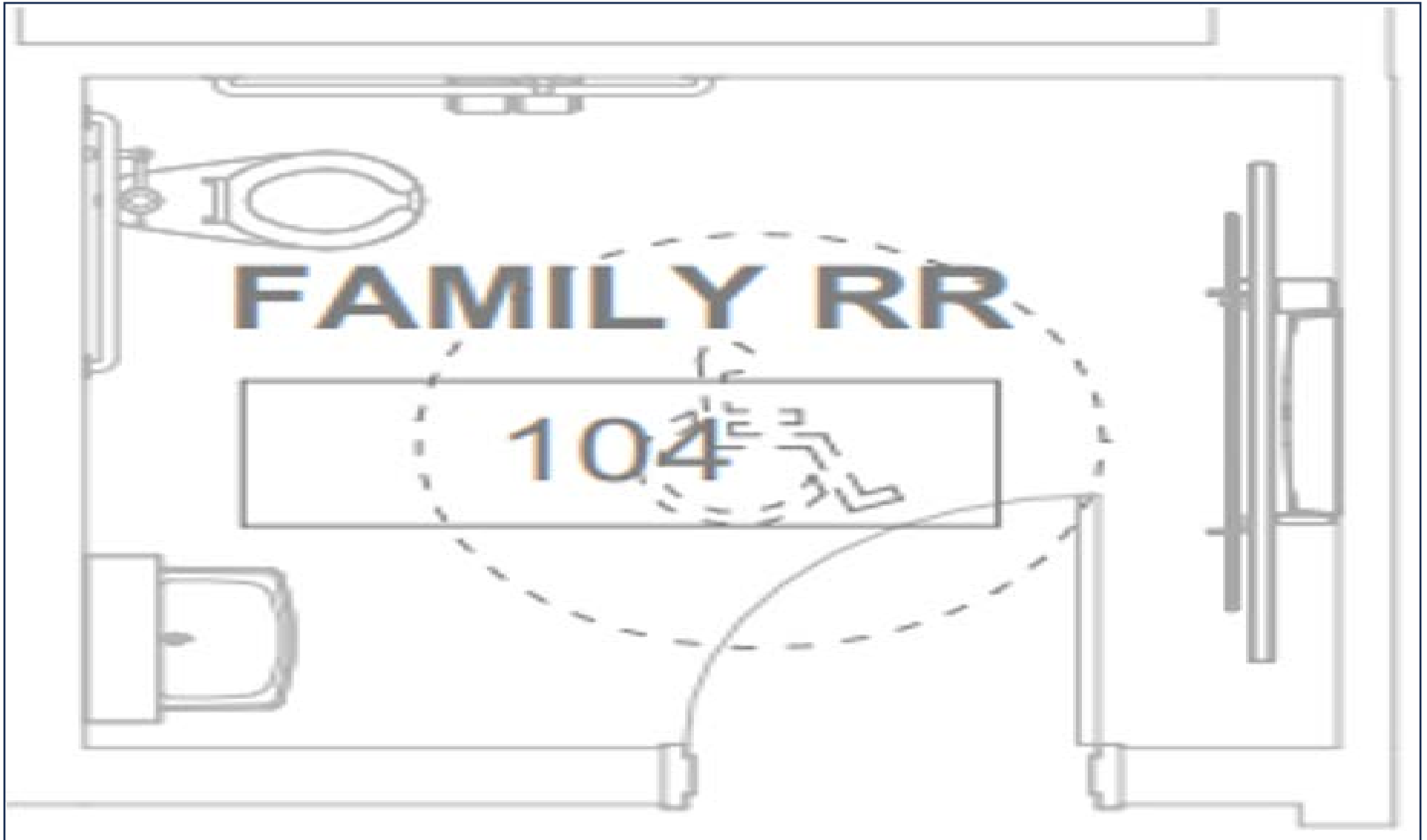

FINISHED LAYOUT

EQUIPMENT

- **COORDINATE WITH OWNER ON EQUIPMENT TO BE REMOVED, DISPOSED OF, OR SALVAGED.**
- **REPAIR EXISTING SPRAY APPLIED FIRE PROOFING DISTURBED AND/OR DAMAGED DURING CONSTRUCTION.**
- **THE INTEGRITY OF RELEVANT STRUCTURAL ELEMENTS SHALL BE MAINTAINED AT ALL TIMES THROUGHOUT DEMOLITION.**
- **CONTRACTOR IS RESPONSIBLE FOR SHORING AND TEMPORARY SUPPORT OF STRUCTURE NECESSARY DUE TO DEMOLITION.**

STRUCTURAL

- **REMOVE DEAD END PIPING AND CONDUIT (FOR EXAMPLE: RISERS WITH NO FLOW, BRANCHES WITH NO FIXTURE). EMPTY RISERS, MAINS, AND BRANCHES FOR FUTURE USE SHALL REMAIN.**
- **VOIDS RESULTING FROM MPE DEMOLITION IN WALL, FLOOR, OR CEILING ASSEMBLIES TO REMAIN SHALL BE PATCHED WITH SOLID MATERIALS MATCHING ADJACENT CONSTRUCTION.**
- **REPAIR EXISTING PIPE AND DUCT INSULATION DAMAGED DURING DEMOLITION.**
- **UTILITIES AND SYSTEMS IN AREAS OUTSIDE THE CONSTRUCTION LIMITS SHALL REMAIN (U.N.O.).**
- **WHERE SMOKE DETECTORS AND/OR DAMPERS LOCATED IN RATED ASSEMBLIES TO REMAIN ARE REMOVED DURING DEMOLITION, NEW SMOKE DAMPERS AND/OR DETECTORS, INCLUDING ALL ELECTRICAL WIRING, SHALL BE RE-INSTALLED AT NO COST.**
- **COORDINATE REQUIRED SHUTDOWNS OF BUILDING SYSTEMS WITH THE OWNER. SHUTDOWNS SHALL BE DONE AT TIMES MOST CONVENIENT TO THE BUILDING OPERATION, SOME OF WHICH MAY BE DURING NIGHTS OR WEEKENDS. OWNER WILL BE NOTIFIED OF ANY SHUTDOWNS TWO DAYS PRIOR.**

MPE SYSTEMS

- **COMPLY WITH REQUIREMENTS OF EPA, CODE OF FEDERAL REGULATIONS, NATIONAL EMISSIONS STANDARDS AND OSHA REGULATIONS ON HAZARDOUS MATERIALS AND ALL OTHER APPLICABLE FEDERAL, STATE AND LOCAL**
- **GOVERNMENT REGULATIONS WHICH ARE INCORPORATED BY REFERENCE.**
- **TDOT DOES NOT ANTICIPATE A NEED FOR REMOVAL OF HAZARDOUS MATERIALS, HOWEVER CONTRACTOR SHALL COORDINATE WITH OWNER ON RESPONSIBILITY OF REMOVAL OF HAZARDOUS MATERIALS SHOULD THE NEED BE IDENTIFIED DURING WORK.**
- **IF HAZARDOUS MATERIALS ARE SUSPECTED OR ENCOUNTERED, IMMEDIATELY SUSPEND WORK IN SUSPECTED AREA OF CONTAMINATION, WITHDRAW FROM AREA AND NOTIFY OWNER IN WRITING.**

SPECIFICATIONS

HAZARDOUS MATERIALS

- DO NOT DISABLE OR DISRUPT BUILDING FIRE OR LIFE SAFETY SYSTEMS WITHOUT PRIOR WRITTEN NOTICE TO OWNER AND LOCAL AUTHORITY HAVING JURISDICTION (AHJ). PROVIDE A MINIMUM OF 3 DAYS NOTICE TO OWNER PRIOR TO DISRUPTION. COORDINATE WITH LOCAL AHJ REGARDING NOTICE REQUIREMENTS.
- ALL NECESSARY PATHS OF EGRESS AND EXITS SHALL BE MAINTAINED 'PROTECTED AND CLEAR' UNLESS ALTERNATE METHODS OF EGRESS ARE PROVIDED THAT ARE ACCEPTABLE TO BUILDING CODE OFFICIALS.
- RELOCATE SECURITY DEVICES, FIRE ALARM ITEMS, EXIT SIGNS, AND EMERGENCY LIGHTING AS REQUIRED DUE TO DEMOLITION OR OBSTRUCTION BY TEMPORARY PARTITIONS.

REGULATORY

- WHERE EXISTING CONSTRUCTION IS TO BE CUT OR REMOVED, PROVIDE SMOOTH AND STRAIGHT CUT JOINTS THAT ARE STRUCTURALLY SOUND. PATCH AND REPAIR ADJOINING SURFACES TO MATCH EXISTING AND PROVIDE IMPERCEPTIBLE TRANSITION, (U.N.O.)
- CEILINGS: REMOVE ENTIRE CEILING SYSTEM AND CEILING MOUNTED ITEMS. STORE DEVICES INTENDED FOR RE-USE.
- WALLS: REMOVE WALL COVERING SYSTEMS SUCH AS PANELING AND VINYL WALL COVERINGS. PATCH / REPAIR HOLES OR DAMAGED AREAS AND SKIM-COAT ENTIRE SURFACE.
- FLOORS: REMOVE FINISH TO SUB-FLOOR, CLEAN ADHESIVES AND GLUES FROM SUBSTRATE, AND PREPARE SUBSTRATE (LEVEL AND FILL AS NEEDED).

ARCHITECTURAL / INTERIORS

- WHERE NEW FINISHES ARE SCHEDULED IN EXISTING SPACES, COORDINATE WITH OWNER & REMOVE ALL OBSOLETE, UNNECESSARY, OR ABANDONED ITEMS IN DEMOLITION AREAS THAT ARE NOT APPROPRIATE TO REMAIN FOR NEW WORK.
- EXISTING CONDITIONS TO REMAIN: DAMAGED COMPONENTS SHALL BE REPAIRED BY THE CONTRACTOR AT NO COST TO THE OWNER. THIS INCLUDES DAMAGE DONE TO EXISTING SPACES ABOVE, BELOW, AND ADJACENT TO, AS REQUIRED TO COMPLETE NEW WORK.
- SURVEY EXISTING CONDITIONS AND CORRELATE WITH REQUIREMENTS INDICATED TO DETERMINE EXTENT OF SELECTIVE DEMOLITION REQUIRED. RECORD EXISTING CONDITIONS BY USE OF ANY COMBINATION OF MEASURED DRAWINGS AND PRECONSTRUCTION PHOTOGRAPHS.
- CEASE OPERATIONS IMMEDIATELY IF STRUCTURE APPEARS TO BE IN DANGER AND NOTIFY
- ARCHITECT/ENGINEER. DO NOT RESUME OPERATIONS UNTIL DIRECTED.

ARCHITECTURAL/INTERIORS CONT.

- **UTILITY SERVICE: MAINTAIN EXISTING UTILITIES INDICATED TO REMAIN IN SERVICE AND PROTECT THEM AGAINST DAMAGE DURING SELECTIVE DEMOLITION OPERATIONS. MAINTAIN FIRE-PROTECTION FACILITIES IN SERVICE DURING SELECTIVE DEMOLITION OPERATIONS.**
- **CONDUCT DEMOLITION TO MINIMIZE INTERFERENCE WITH OWNER'S NORMAL OPERATIONS AND WITH ADJACENT BUILDING AREAS.**
- **PROVIDE TEMPORARY DUST PARTITIONS, SECURITY DEVICES, AND OTHER MEANS NECESSARY FOR THE PROTECTION OF OCCUPANTS WHERE TRAFFIC IN CORRIDORS AND SPACES ADJACENT TO DEMOLITION / RENOVATION WORK ARE IMPACTED.**
- **CONTRACTOR TO MEET ALL FACILITY OR REGULATORY REQUIREMENTS RELATED TO PROTECTION OF OCCUPANTS.**

EXISTING CONDITIONS

- **REFER TO STRUCTURAL, MECHANICAL, PLUMBING, ELECTRICAL, AND VENDOR (IF APPLICABLE) DRAWINGS AND SPECIFICATIONS FOR ADDITIONAL DEMOLITION ITEMS AND INFORMATION.**
 - **EXISTING WARRANTIES: REMOVE, REPLACE, PATCH, AND REPAIR MATERIALS AND SURFACES CUT OR DAMAGED DURING SELECTIVE DEMOLITION, BY METHODS AND WITH MATERIALS SO AS NOT TO VOID EXISTING... REMOVED & REINSTALLED ITEMS: CLEAN & REPAIR ITEMS TO FUNCTIONAL CONDITION ADEQUATE FOR INTENDED USE, PACK OR CRATE AFTER CLEANING / REPAIR AND IDENTIFY CONTENTS OF CONTAINERS,**
 - **PROTECT ITEMS FROM DAMAGE DURING TRANSPORT / STORAGE, REINSTALL ITEMS IN LOCATIONS INDICATED.**
 - **REMOVED & SALVAGED ITEMS: CLEAN ITEMS, PACK OR CRATE AFTER CLEANING AND IDENTIFY CONTENTS OF CONTAINERS, PROTECT AND TRANSPORT ITEMS TO OWNER'S STORAGE AREA ON-SITE.**
 - **REMOVE CONSTRUCTION SHOWN DASHED ON DEMOLITION PLAN. REFERENCE LEGEND FOR MORE SPECIFIC INFORMATION.**
 - **PRIOR TO START, HOLD A PRE-DEMOLITION CONFERENCE AT THE PROJECT SITE TO REVIEW METHODS AND PROCEDURES RELATED TO DEMOLITION. COORDINATE WITH OWNER REGARDING CONSTRUCTION ACCESS,**
 - **TRANSPORTATION AND DISPOSAL OF DEBRIS, AND OTHER FACILITY REQUIREMENTS RELATED TO CONSTRUCTION.**
 - **COORDINATE SCOPE OF DEMOLITION WORK TO INSTALL NEW WORK SHOWN ELSEWHERE IN THE CONTRACT**
 - **DOCUMENTS. (FOR EXAMPLE, IF NEW FINISHES ARE SCHEDULED FOR AN EXISTING AREA TO REMAIN, REMOVE EXISTING FINISHES PRIOR TO INSTALLATION OF NEW FINISHES EVEN IF NOT EXPLICITLY IDENTIFIED ON DEMOLITION PLAN.)**
- **INSTALLATION**
 - **DOOR SHALL HAVE AN OVERHEAD STOP ADJUSTED TO STOP BEFORE IT WOULD HIT THE CHANGING STATION.**

SPECIFICATIONS CONT.

EXISTING CONDITIONS CONT.

- MATCH EXISTING TILE PATTERN
- A POWER SOURCE WILL BE REQUIRED TO OPERATE THE CHANGING TABLE.
- CLOSEST OUTLET SHALL BE LOCATED ON THE SITE AND POWER PULLED TO THE TABLE.
- ADULT CHANGING TABLE. BASIS OF DESIGN.
- REFER TO INSTALLATION MANUAL FOR TYPES OF FASTNERS REQUIRED FOR ATTACHMENT TO WOOD, EMPTY/POURED CONCRETE BLOCK.

ELECTRIC POWERED ADULT WALL MOUNTED CHANGING TABLE

ACCEPTABLE BRANDS/MODELS: ASTOR BANNERMAN INVINCIBLE, PRESSALIT CT4000 VERSAMAX, OR EQUAL*

SPECIFICATIONS:

WORKING LOAD: MINIMUM 440 POUNDS

TOTAL MAXIMUM WIDTH SHALL NOT EXCEED 41" FROM WALL WHEN TABLE/STRETCHER IS DEPLOYED

TABLE/STRETCHER DIMENSIONS:

- **LENGTH: MINIMUM 70" – MAXIMUM 72"**
- **WIDTH: MINIMUM 30" – MAXIMUM 32"**

TABLE/STRETCHER SURFACE TO BE DESIGNED FOR EASY CLEAN-UP.

ADJUSTABLE HEIGHT RANGE OF 12" FROM FLOOR TO 39" FROM FLOOR

TABLE/STRETCHER TO MANUALLY FOLD UP WHEN NOT IN USE.

FOLD DOWN SAFETY RAIL ON FRONT OF TABLE/STRETCHER.

INTEGRATED FRONT CONTROL PANEL FOR RAISING AND LOWERING TABLE/STRETCHER.

ELECTRICAL REQUIREMENT: 120 VOLT

***IF BIDDING AN EQUAL BRAND PLEASE SUBMIT LITERATURE THAT SUBSTANTIATES THE ITEM BID MEETS SPECIFICATIONS.**



George Leo Hagewood
Facilities Manager 3
Maintenance Operations Division
James K. Polk Bldg., Suite 400
505 Deaderick St. Nashville, TN. 37243
C:615-806-3045

Timothy Worley, Transportation Manager 1
Maintenance Operations Division
James K Polk Building, Suite 400
505 Deaderick Street, Nashville TN 37243
C: 423-208-7440

I-24 East Marion County Rest Area MM160



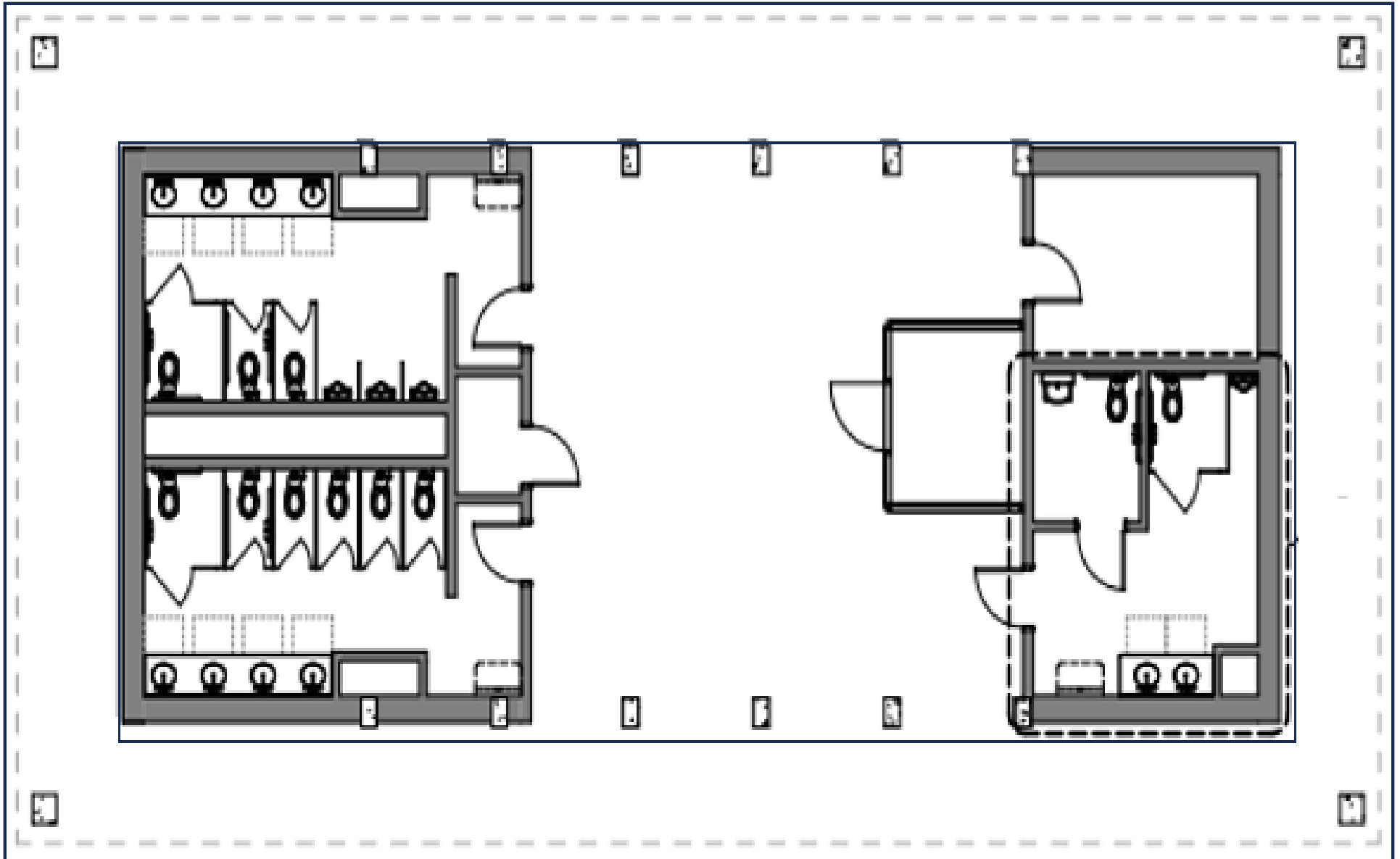

EXISTING FLOOR PLAN

KEYNOTES

- 1 REMOVE ASSIST RAILS, TOILET, AND PAPER DISPENSER
- 2 REMOVE WALL, DOOR/FRAME
- 3 REMOVE PARTITION/DOOR

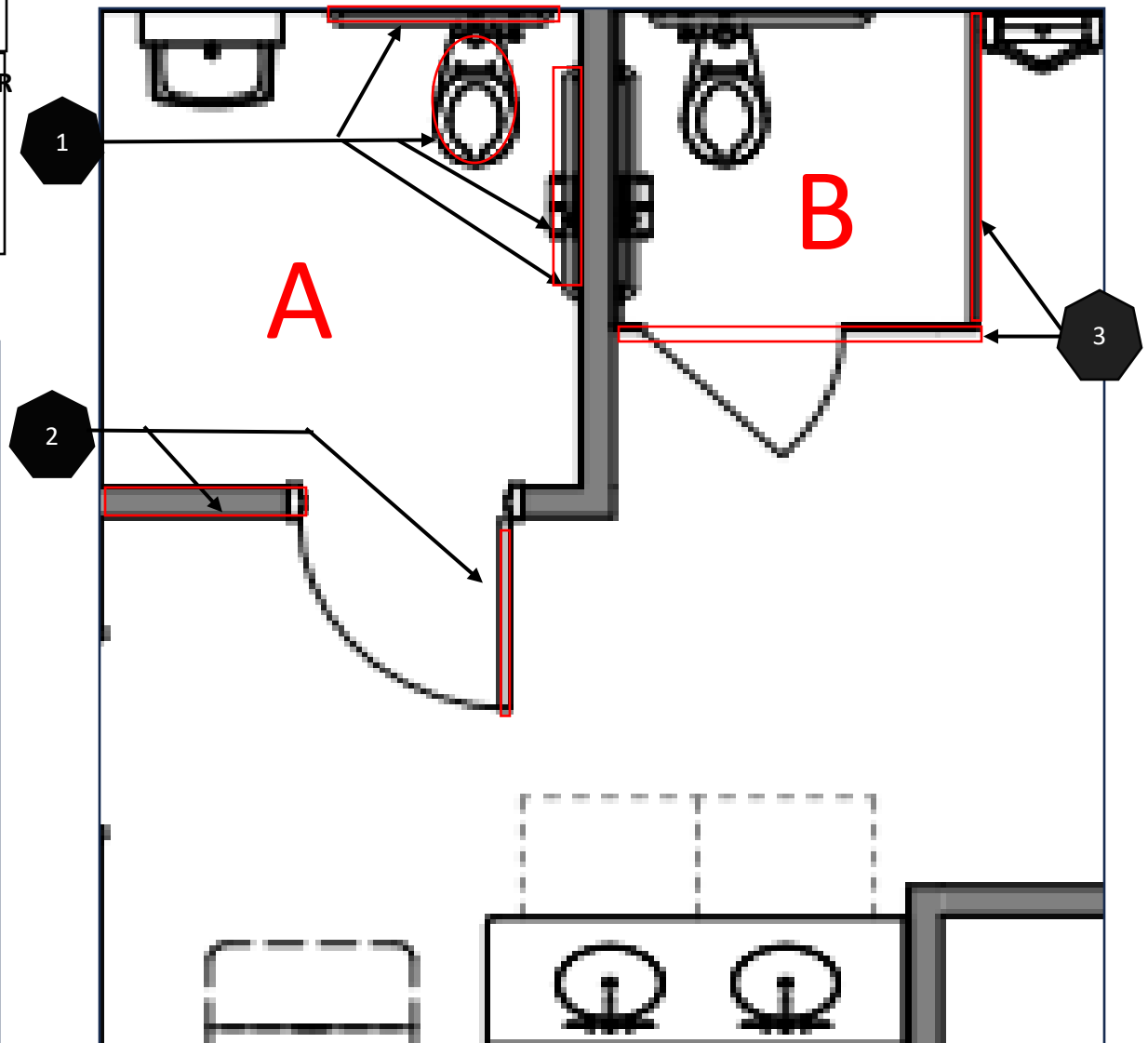

ENLARGED DEMO PLANS/PHOTO

REMOVAL OF:

- ASSIST RAILING, TOILET DISPENSER, AND TOILET AS INDICATED IN KEYNOTE 1 (AREA **A**). THIS INCLUDES:
 - CAP UTILITIES
 - FINISH DRYWALL/PAINT EXISTING HOLES DURING DEMO

- DOOR, THRESHOLD, AND WALL AS INDICATED IN KEYNOTE 2 (AREA **A**). THIS INCLUDES:
 - FINISH DRYWALL /PAINTING DUE TO DEMO.
 - REPLACEMENT OF ANY TILE (AS CLOSE TO MATCH) DURING DEMO.

- PARTITION WALL AS INDICATED IN KEYNOTE 3 (AREA **B**). THIS INCLUDES:
 - FINISH DRYWALL/PAINT EXISTING HOLE DURING DEMO.

NOTE:

- TAKE CARE TO PROTECT EXISTING TILE DURING DEMO. ANY DAMAGE TO TILE/GROUT OR ANY OTHER PORTIONS OF THE WALL OR FLOOR SHALL BE REPAIRED AT THE EXPENSE OF THE CONTRACTOR.
- CONTRACTOR WILL BE RESPONSIBLE FOR REMOVING ALL DEBRIS OFF SITE.

KEYNOTES

- 1 INSTALL ACCEPTABLE BRANDS/MODEL CHANGING TABLE
- 2 INSTALL PAPER TOWEL DISPENSER
- 3 INSTALL TRIPLE WOOD HEADER
- 4 INSTALL NEW PARTITION/DOOR

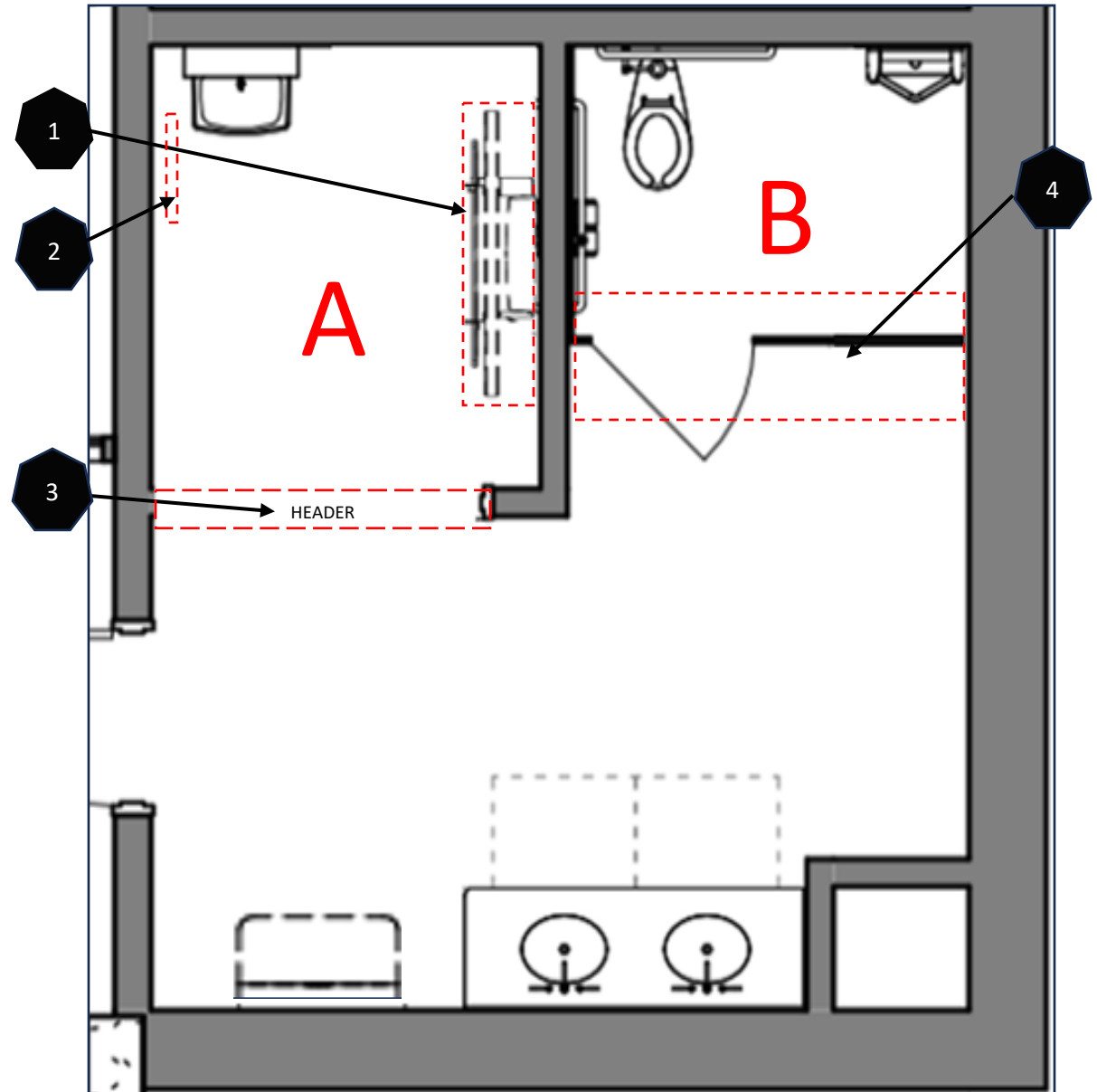
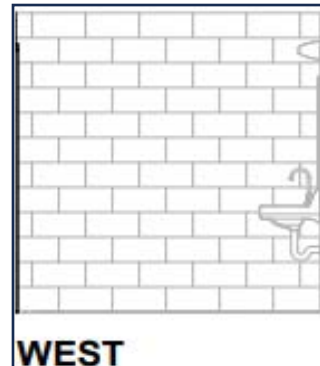
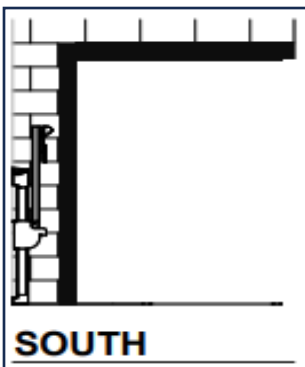
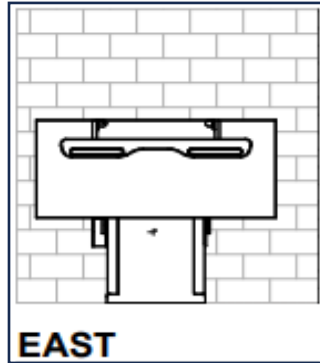

INSTALL LAYOUT

INSTALLATION OF:

- **ACCEPTABLE BRANDS/MODELS: ASTOR BANNERMAN INVINCIBLE, PRESSALIT CT4000 VERSAMAX, OR EQUAL* AS INDICATED IN KEYNOTE 1 (AREA A). THIS INCLUDES:**
 - REVIEWING THE INSTALLATION MANUAL FOR REQUIRED FASTENERS TO SUPPORT THE 440 LBS.
 - ANY ADDITIONAL WALL/STUD SUPPORT FOR MOUNTING.
- **PAPER TOWEL DISPENSER AS INDICATED IN KEYNOTE 2 (AREA A). THIS INCLUDES:**
 - INSTALLING TO ADA SPECIFICATIONS
- **6X6 TRIPLE HEADER AS INDICATED IN KEYNOTE 3 (AREA A). THIS INCLUDES:**
 - DRYWALL/PAINT TO FINISH MATCHING EXISTING FINISH.
- **HDPE SOLID PARTITION AS INDICATED IN KEYNOTE 4 (AREA B).**

NOTE:

- ANY DAMAGES DURING INSTALLATION SHALL BE REPAIRED AT THE EXPENSE OF THE CONTRACTOR
- POINT OF CONTACT SHALL BE NOTIFIED SHOULD ANY ADDITIONAL CHANGES ARE NEEDED OUTSIDE THE SCOPE OF WORK.
- CONTRACTOR SHALL BE RESPONSIBLE FOR SUPPLYING ALL HARDWARE NEEDED FOR INSTALL.

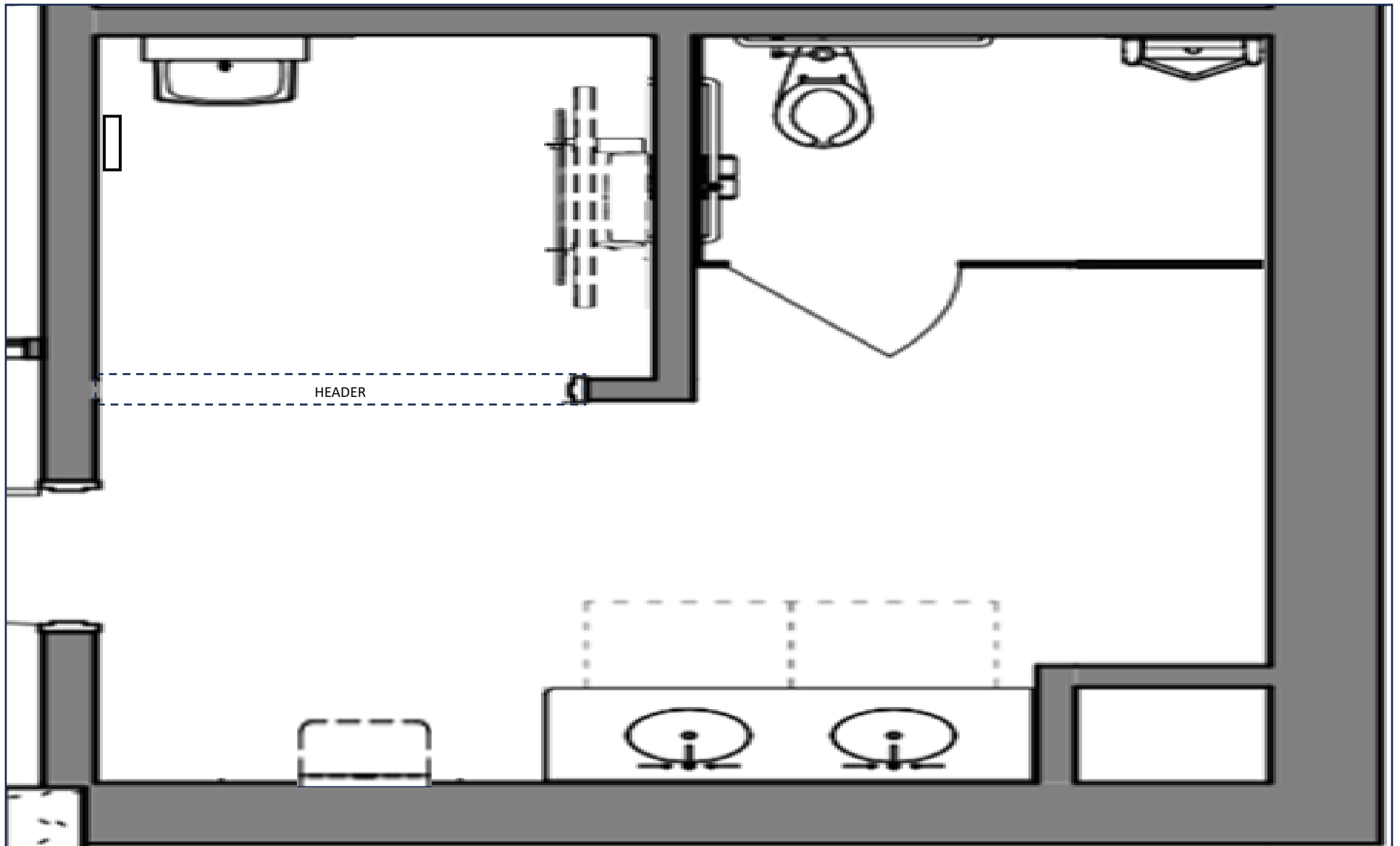

FINISHED LAYOUT

EQUIPMENT

- **COORDINATE WITH OWNER ON EQUIPMENT TO BE REMOVED, DISPOSED OF, OR SALVAGED.**
- **REPAIR EXISTING SPRAY APPLIED FIRE PROOFING DISTURBED AND/OR DAMAGED DURING CONSTRUCTION.**
- **THE INTEGRITY OF RELEVANT STRUCTURAL ELEMENTS SHALL BE MAINTAINED AT ALL TIMES THROUGHOUT DEMOLITION.**
- **CONTRACTOR IS RESPONSIBLE FOR SHORING AND TEMPORARY SUPPORT OF STRUCTURE NECESSARY DUE TO DEMOLITION.**

STRUCTURAL

- **REMOVE DEAD END PIPING AND CONDUIT (FOR EXAMPLE: RISERS WITH NO FLOW, BRANCHES WITH NO FIXTURE). EMPTY RISERS, MAINS, AND BRANCHES FOR FUTURE USE SHALL REMAIN.**
- **VOIDS RESULTING FROM MPE DEMOLITION IN WALL, FLOOR, OR CEILING ASSEMBLIES TO REMAIN SHALL BE PATCHED WITH SOLID MATERIALS MATCHING ADJACENT CONSTRUCTION.**
- **REPAIR EXISTING PIPE AND DUCT INSULATION DAMAGED DURING DEMOLITION.**
- **UTILITIES AND SYSTEMS IN AREAS OUTSIDE THE CONSTRUCTION LIMITS SHALL REMAIN (U.N.O.).**
- **WHERE SMOKE DETECTORS AND/OR DAMPERS LOCATED IN RATED ASSEMBLIES TO REMAIN ARE REMOVED DURING DEMOLITION, NEW SMOKE DAMPERS AND/OR DETECTORS, INCLUDING ALL ELECTRICAL WIRING, SHALL BE RE-INSTALLED AT NO COST.**
- **COORDINATE REQUIRED SHUTDOWNS OF BUILDING SYSTEMS WITH THE OWNER. SHUTDOWNS SHALL BE DONE AT TIMES MOST CONVENIENT TO THE BUILDING OPERATION, SOME OF WHICH MAY BE DURING NIGHTS OR WEEKENDS. OWNER WILL BE NOTIFIED OF ANY SHUTDOWNS TWO DAYS PRIOR.**

MPE SYSTEMS

- **COMPLY WITH REQUIREMENTS OF EPA, CODE OF FEDERAL REGULATIONS, NATIONAL EMISSIONS STANDARDS AND OSHA REGULATIONS ON HAZARDOUS MATERIALS AND ALL OTHER APPLICABLE FEDERAL, STATE AND LOCAL**
- **GOVERNMENT REGULATIONS WHICH ARE INCORPORATED BY REFERENCE.**
- **TDOT DOES NOT ANTICIPATE A NEED FOR REMOVAL OF HAZARDOUS MATERIALS, HOWEVER CONTRACTOR SHALL COORDINATE WITH OWNER ON RESPONSIBILITY OF REMOVAL OF HAZARDOUS MATERIALS SHOULD THE NEED BE IDENTIFIED DURING WORK.**
- **IF HAZARDOUS MATERIALS ARE SUSPECTED OR ENCOUNTERED, IMMEDIATELY SUSPEND WORK IN SUSPECTED AREA OF CONTAMINATION, WITHDRAW FROM AREA AND NOTIFY OWNER IN WRITING.**

HAZARDOUS MATERIALS

- **DO NOT DISABLE OR DISRUPT BUILDING FIRE OR LIFE SAFETY SYSTEMS WITHOUT PRIOR WRITTEN NOTICE TO OWNER AND LOCAL AUTHORITY HAVING JURISDICTION (AHJ). PROVIDE A MINIMUM OF 3 DAYS NOTICE TO OWNER PRIOR TO DISRUPTION. COORDINATE WITH LOCAL AHJ REGARDING NOTICE REQUIREMENTS.**
- **ALL NECESSARY PATHS OF EGRESS AND EXITS SHALL BE MAINTAINED 'PROTECTED AND CLEAR' UNLESS ALTERNATE METHODS OF EGRESS ARE PROVIDED THAT ARE ACCEPTABLE TO BUILDING CODE OFFICIALS.**
- **RELOCATE SECURITY DEVICES, FIRE ALARM ITEMS, EXIT SIGNS, AND EMERGENCY LIGHTING AS REQUIRED DUE TO DEMOLITION OR OBSTRUCTION BY TEMPORARY PARTITIONS.**

REGULATORY

- **WHERE EXISTING CONSTRUCTION IS TO BE CUT OR REMOVED, PROVIDE SMOOTH AND STRAIGHT CUT JOINTS THAT ARE STRUCTURALLY SOUND. PATCH AND REPAIR ADJOINING SURFACES TO MATCH EXISTING AND PROVIDE IMPERCEPTIBLE TRANSITION, (U.N.O.)**
- **CEILINGS: REMOVE ENTIRE CEILING SYSTEM AND CEILING MOUNTED ITEMS. STORE DEVICES INTENDED FOR RE-USE.**
- **WALLS: REMOVE WALL COVERING SYSTEMS SUCH AS PANELING AND VINYL WALL COVERINGS. PATCH / REPAIR HOLES OR DAMAGED AREAS AND SKIM-COAT ENTIRE SURFACE.**
- **FLOORS: REMOVE FINISH TO SUB-FLOOR, CLEAN ADHESIVES AND GLUES FROM SUBSTRATE, AND PREPARE SUBSTRATE (LEVEL AND FILL AS NEEDED).**

ARCHITECTURAL / INTERIORS

- **WHERE NEW FINISHES ARE SCHEDULED IN EXISTING SPACES, COORDINATE WITH OWNER & REMOVE ALL OBSOLETE, UNNECESSARY, OR ABANDONED ITEMS IN DEMOLITION AREAS THAT ARE NOT APPROPRIATE TO REMAIN FOR NEW WORK.**
- **EXISTING CONDITIONS TO REMAIN: DAMAGED COMPONENTS SHALL BE REPAIRED BY THE CONTRACTOR AT NO COST TO THE OWNER. THIS INCLUDES DAMAGE DONE TO EXISTING SPACES ABOVE, BELOW, AND ADJACENT TO, AS REQUIRED TO COMPLETE NEW WORK.**
- **SURVEY EXISTING CONDITIONS AND CORRELATE WITH REQUIREMENTS INDICATED TO DETERMINE EXTENT OF SELECTIVE DEMOLITION REQUIRED. RECORD EXISTING CONDITIONS BY USE OF ANY COMBINATION OF MEASURED DRAWINGS AND PRECONSTRUCTION PHOTOGRAPHS.**
- **CEASE OPERATIONS IMMEDIATELY IF STRUCTURE APPEARS TO BE IN DANGER AND NOTIFY**
- **ARCHITECT/ENGINEER. DO NOT RESUME OPERATIONS UNTIL DIRECTED.**

ARCHITECTURAL/INTERIORS CONT.

- **UTILITY SERVICE: MAINTAIN EXISTING UTILITIES INDICATED TO REMAIN IN SERVICE AND PROTECT THEM AGAINST DAMAGE DURING SELECTIVE DEMOLITION OPERATIONS. MAINTAIN FIRE-PROTECTION FACILITIES IN SERVICE DURING SELECTIVE DEMOLITION OPERATIONS.**
- **CONDUCT DEMOLITION TO MINIMIZE INTERFERENCE WITH OWNER'S NORMAL OPERATIONS AND WITH ADJACENT BUILDING AREAS.**
- **PROVIDE TEMPORARY DUST PARTITIONS, SECURITY DEVICES, AND OTHER MEANS NECESSARY FOR THE PROTECTION OF OCCUPANTS WHERE TRAFFIC IN CORRIDORS AND SPACES ADJACENT TO DEMOLITION / RENOVATION WORK ARE IMPACTED.**
- **CONTRACTOR TO MEET ALL FACILITY OR REGULATORY REQUIREMENTS RELATED TO PROTECTION OF OCCUPANTS.**

EXISTING CONDITIONS

- **REFER TO STRUCTURAL, MECHANICAL, PLUMBING, ELECTRICAL, AND VENDOR (IF APPLICABLE) DRAWINGS AND SPECIFICATIONS FOR ADDITIONAL DEMOLITION ITEMS AND INFORMATION.**
- **EXISTING WARRANTIES: REMOVE, REPLACE, PATCH, AND REPAIR MATERIALS AND SURFACES CUT OR DAMAGED DURING SELECTIVE DEMOLITION, BY METHODS AND WITH MATERIALS SO AS NOT TO VOID EXISTING... REMOVED & REINSTALLED ITEMS: CLEAN & REPAIR ITEMS TO FUNCTIONAL CONDITION ADEQUATE FOR INTENDED USE, PACK OR CRATE AFTER CLEANING / REPAIR AND IDENTIFY CONTENTS OF CONTAINERS,**
- **PROTECT ITEMS FROM DAMAGE DURING TRANSPORT / STORAGE, REINSTALL ITEMS IN LOCATIONS INDICATED.**
- **REMOVED & SALVAGED ITEMS: CLEAN ITEMS, PACK OR CRATE AFTER CLEANING AND IDENTIFY CONTENTS OF CONTAINERS, PROTECT AND TRANSPORT ITEMS TO OWNER'S STORAGE AREA ON-SITE.**
- **REMOVE CONSTRUCTION SHOWN DASHED ON DEMOLITION PLAN. REFERENCE LEGEND FOR MORE SPECIFIC INFORMATION.**
- **PRIOR TO START, HOLD A PRE-DEMOLITION CONFERENCE AT THE PROJECT SITE TO REVIEW METHODS AND PROCEDURES RELATED TO DEMOLITION. COORDINATE WITH OWNER REGARDING CONSTRUCTION ACCESS,**
- **TRANSPORTATION AND DISPOSAL OF DEBRIS, AND OTHER FACILITY REQUIREMENTS RELATED TO CONSTRUCTION.**
- **COORDINATE SCOPE OF DEMOLITION WORK TO INSTALL NEW WORK SHOWN ELSEWHERE IN THE CONTRACT**
- **DOCUMENTS. (FOR EXAMPLE, IF NEW FINISHES ARE SCHEDULED FOR AN EXISTING AREA TO REMAIN, REMOVE EXISTING FINISHES PRIOR TO INSTALLATION OF NEW FINISHES EVEN IF NOT EXPLICITLY IDENTIFIED ON DEMOLITION PLAN.)**
- **INSTALLATION**
 - **DOOR SHALL HAVE AN OVERHEAD STOP ADJUSTED TO STOP BEFORE IT WOULD HIT THE CHANGING STATION.**

EXISTING CONDITIONS CONT.

- **MATCH EXISTING TILE PATTERN**
- **A POWER SOURCE WILL BE REQUIRED TO OPERATE THE CHANGING TABLE. CLOSEST**
- **OUTLET SHALL BE LOCATED ON THE SITE AND POWER PULLED TO THE TABLE.**
- **ADULT CHANGING TABLE. BASIS OF DESIGN.**
- **REFER TO INSTALLATION MANUAL FOR TYPES OF FASTNERS REQUIRED FOR ATTACHMENT TO WOOD, EMPTY/POURED CONCRETE BLOCK.**

ELECTRIC POWERED ADULT WALL MOUNTED CHANGING TABLE

ACCEPTABLE BRANDS/MODELS: ASTOR BANNERMAN INVINCIBLE, PRESSALIT CT4000 VERSAMAX, OR EQUAL*

SPECIFICATIONS:

WORKING LOAD: MINIMUM 440 POUNDS

TOTAL MAXIMUM WIDTH SHALL NOT EXCEED 41" FROM WALL WHEN TABLE/STRETCHER IS DEPLOYED

TABLE/STRETCHER DIMENSIONS:

- **LENGTH: MINIMUM 70" – MAXIMUM 72"**
- **WIDTH: MINIMUM 30" – MAXIMUM 32"**

TABLE/STRETCHER SURFACE TO BE DESIGNED FOR EASY CLEAN-UP.

ADJUSTABLE HEIGHT RANGE OF 12" FROM FLOOR TO 39" FROM FLOOR

TABLE/STRETCHER TO MANUALLY FOLD UP WHEN NOT IN USE.

FOLD DOWN SAFETY RAIL ON FRONT OF TABLE/STRETCHER.

INTEGRATED FRONT CONTROL PANEL FOR RAISING AND LOWERING TABLE/STRETCHER.

ELECTRICAL REQUIREMENT: 120 VOLT

***IF BIDDING AN EQUAL BRAND PLEASE SUBMIT LITERATURE THAT SUBSTANTIATES THE ITEM BID MEETS SPECIFICATIONS.**



George Leo Hagewood
Facilities Manager 3
Maintenance Operations Division
James K. Polk Bldg., Suite 400
505 Deaderick St. Nashville, TN. 37243
C:615-806-3045

Tim Worley | Transportation Manager 1
Maintenance Operations Division
TDOT Headquarters
James K. Polk Building, 4th Floor
505 Deaderick Street, Nashville, TN 37243
C: 423-208-7440

UNICOI/GILES/HAMILTON/CAMPBELL/SULLIVAN COUNTY WC



UNICOI WELCOME CENTER

100 FIDDLERS LN, TN 373650

HAMILTON WELCOME CENTER

100 I-24, CHATTANOOGA, TN 37419

GILES WELCOME CENTER

INTERSTATE 65 MILE MARKER 3.1 NORTHBOUND

ARDMORE, TN 38449

CAMPBELL WELCOME CENTER

INTERSTATE 75 SOUTHBOUND MILE MARKER 161,

481 HOLIDAY LN, JELICO, TN 37762

SULLIVAN WELCOME CENTER

INTERSTATE 26 MILE MARKER 5, KINGSPORT, TN 37664

PROPOSED LOCATIONS



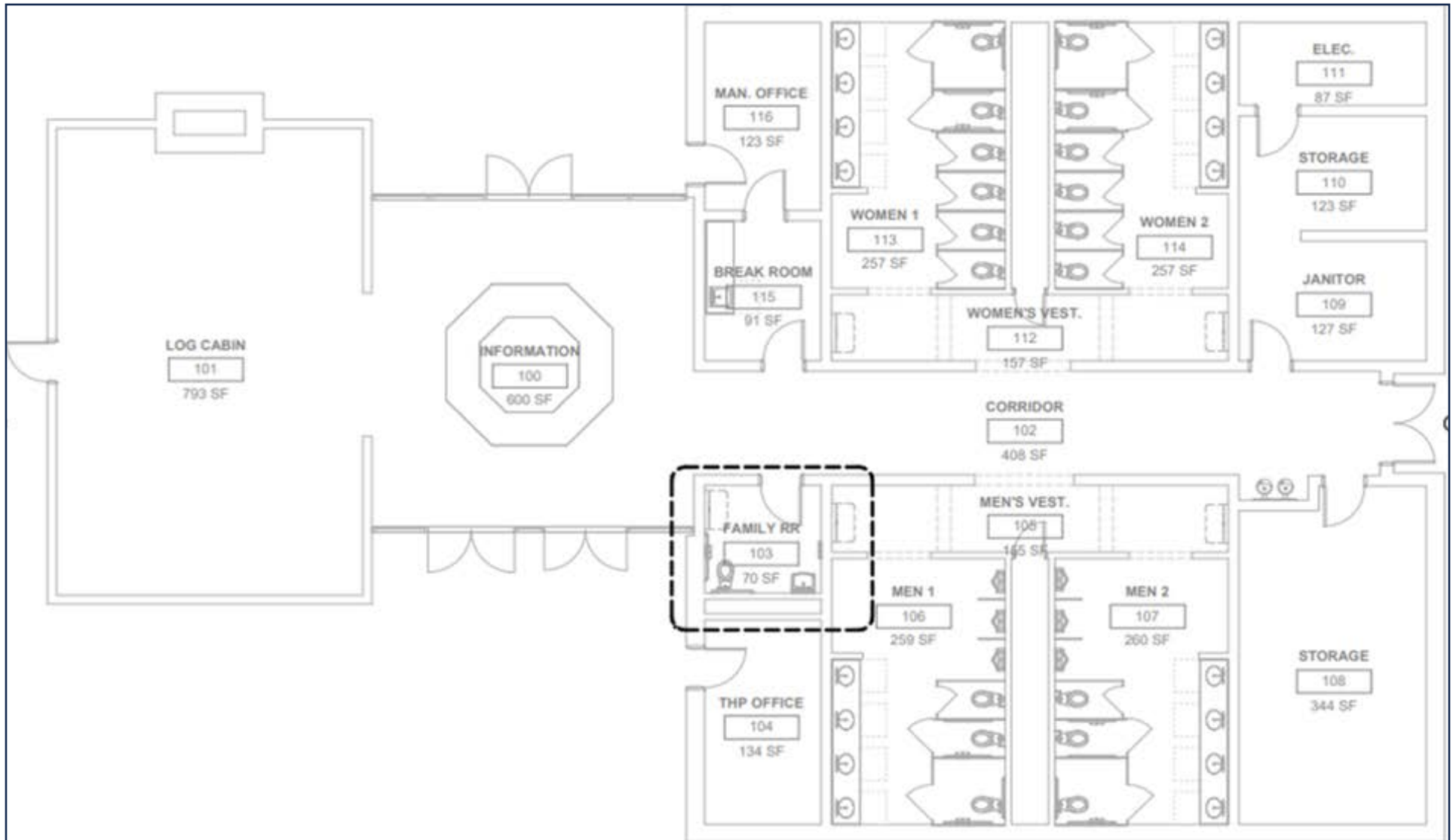

EXISTING FLOOR PLAN

KEYNOTES

1 REMOVE BABY CHANGING TABLE

2 REMOVE SINK

3 REMOVE MIRROR/PAPER DISPENSER/SOAP DISPENSER

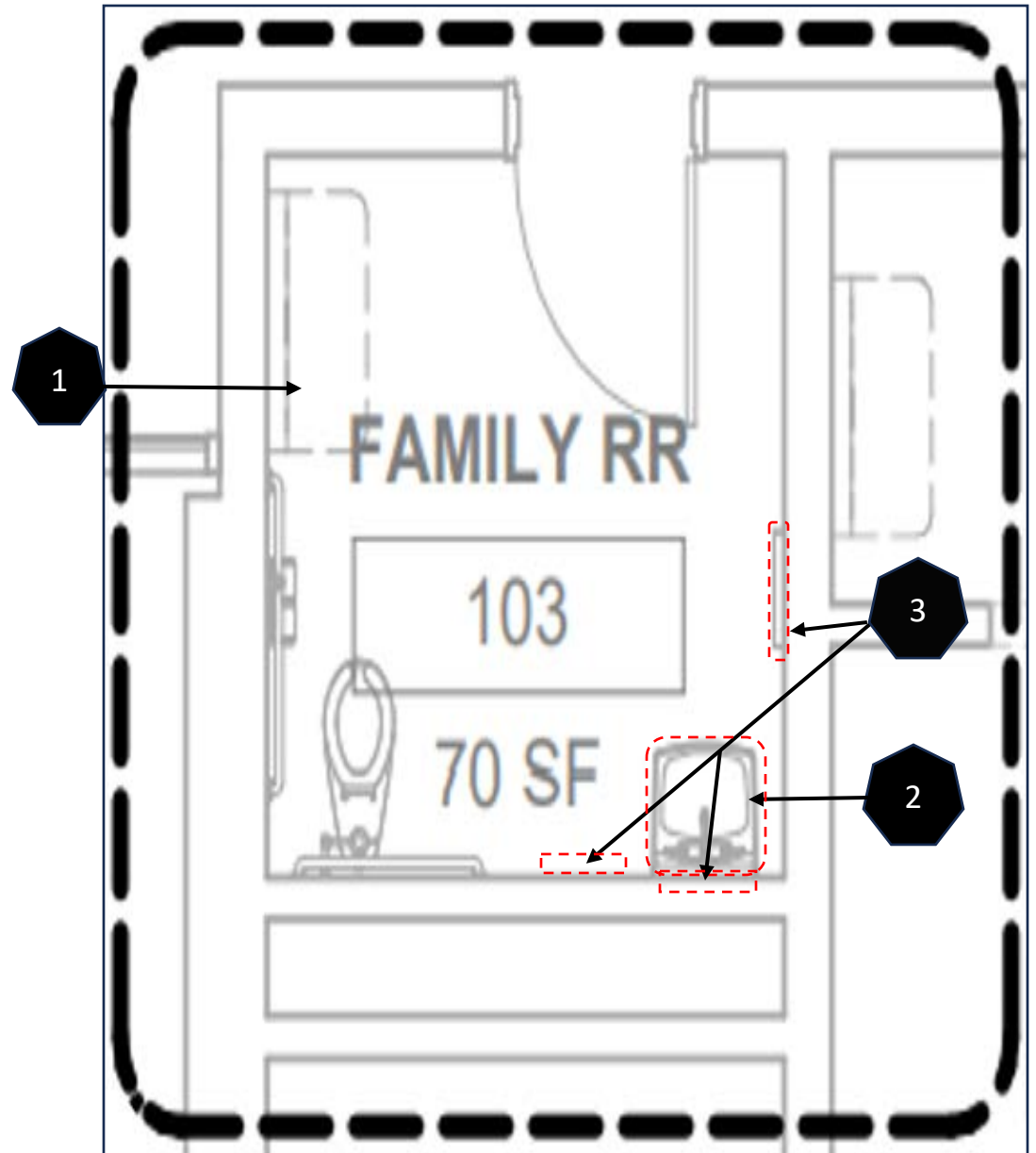
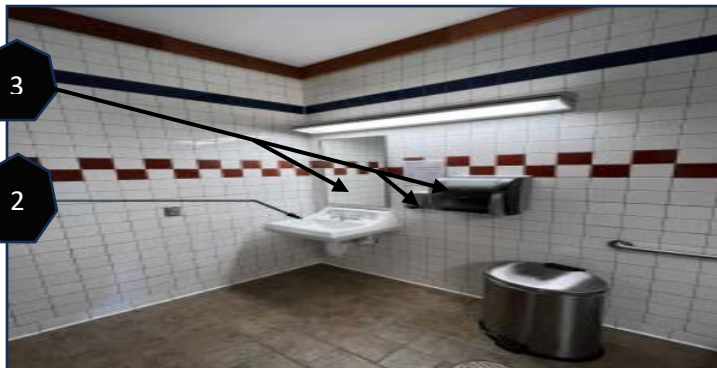
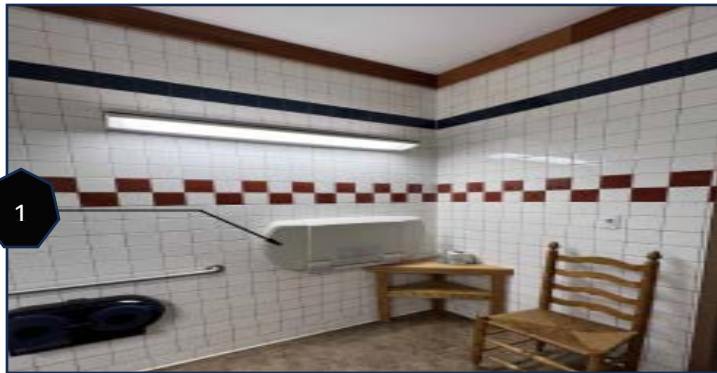

ENLARGED DEMO PLANS/PHOTOS

REMOVAL OF:

- **BABY CHANGING STATION AS INDICATED IN KEYNOTE 1. THIS INCLUDES:**
 - **FILL ANY EXISTING HOLE DURING DEMO**
- **SINK AS INDICATED IN KEYNOTE 2. THIS INCLUDES:**
 - **CAPPING UTILITIES REMOVED**
 - **FILL ANY EXISTING HOLE DURING DEMO**
- **MIRROR/PAPER DISPENSER/SOAP DISPENSER AS INDICATED IN KEYNOTE 3. THIS INCLUDES:**
 - **FILL ANY EXISTING HOLES DURING DEMO**

NOTE:

- **TAKE CARE TO PROTECT EXISTING TILE DURING DEMO. ANY DAMAGE TO TILE/GROUT OR ANY OTHER PORTIONS OF THE WALL OR FLOOR SHALL BE REPAIRED AT THE EXPENSE OF THE CONTRACTOR.**
- **CONTRACTOR WILL BE RESPONSIBLE FOR REMOVING ALL DEBRIS OFF SITE.**

KEYNOTES

1 RE-INSTALL SINK

2 RE-INSTALL MIRROR/PAPER DISPENSER/SOAP DISPENSER/
(LIGHTING RE-CENTERED)

3 INSTALL ACCEPTABLE BRAND/MODEL CHANGING TABLE

4 WALL OR BASE CHASE NEED FOR PLUMBING

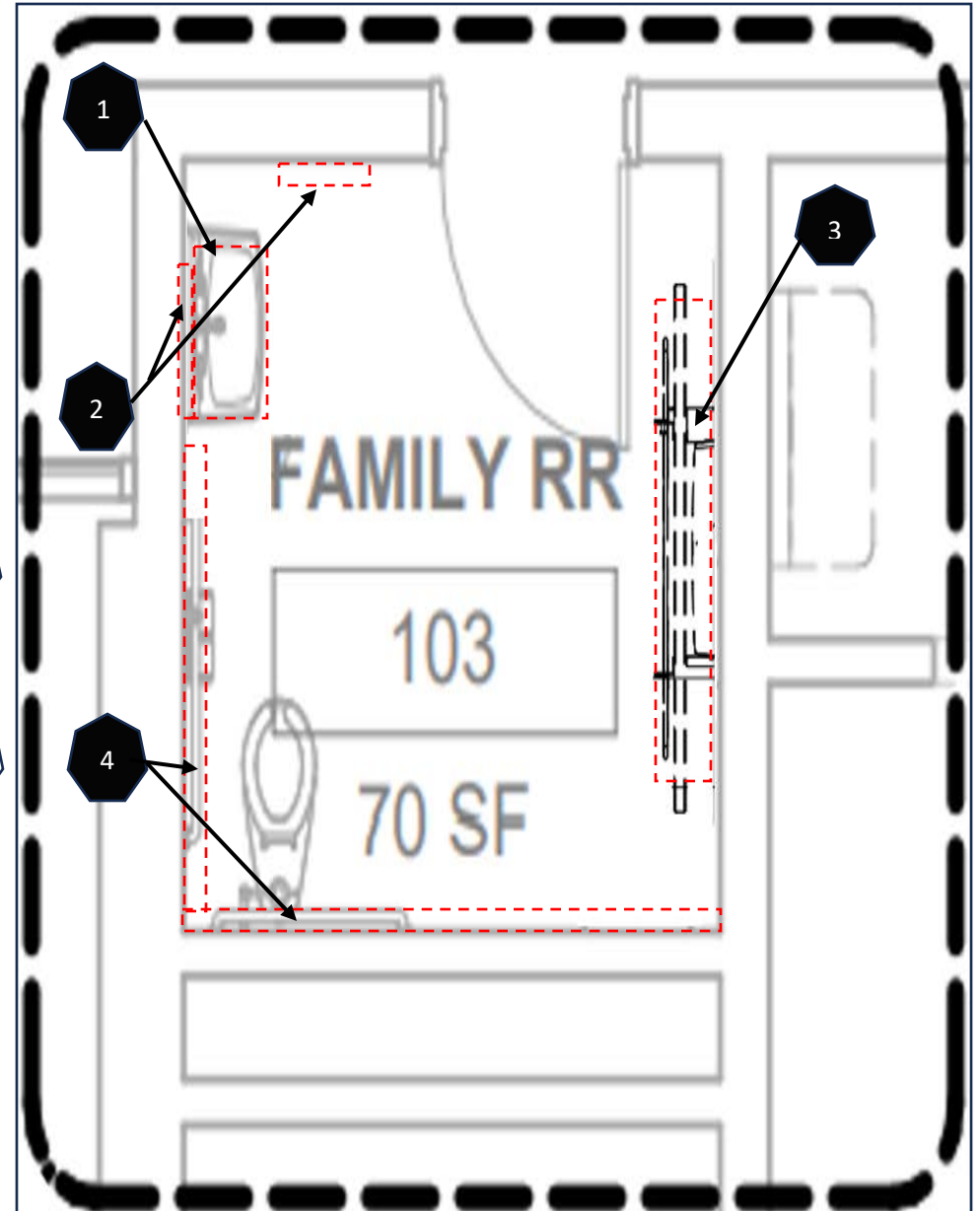
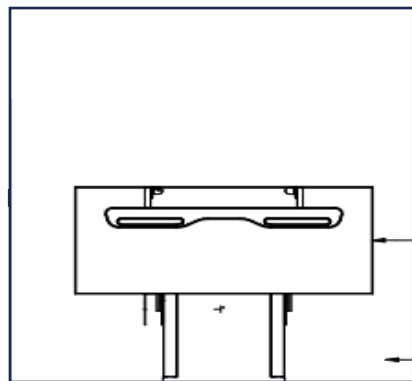
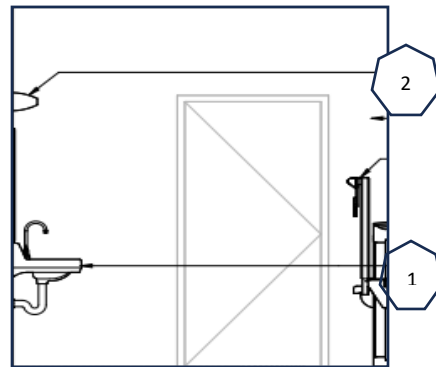
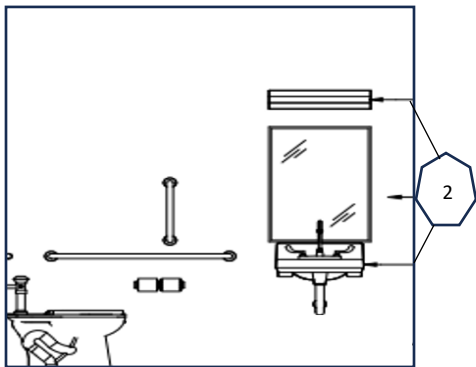

INSTALL LAYOUT

INSTALLATION OF:

- **EXISTING SINK AS INDICATED ON PAGE 6/KEYNOTE 1. THIS INCLUDES:**
 - **WATER/DRAINAGE SUPPLY**
 - **ENSURE THAT SINK MEETS ADA STANDARDS (HEIGHT)**

- **MIRROR/PAPER DISPENSER/SOAP DISPENSER/LIGHTING AS INDICATED ON PAGE 6/KEYNOTE 2. THIS INCLUDES:**
 - **ENSURE THAT MIRROR MEETS ADA STANDARDS (HEIGHT)**
 - **PAPER DISPENSER AND SOAP DISPENSER MEETS ADA STANDARDS (HEIGHT AND LOCATION)**
 - **LIGHTING IS CENTERED WITH SINK/MIRROR (ADJUSTMENTS MAY BE REQUIRED DUE 4FT-6FT EXISTING LIGHTING)**

- **ACCEPTABLE BRANDS/MODELS: ASTOR BANNERMAN INVINCIBLE, PRESSALIT CT4000 VERSAMAX, OR EQUAL* AS INDICATED ON PAGE 6/KEYNOTE 3. THIS INCLUDES:**
 - **REVIEWING THE INSTALLATION MANUAL FOR REQUIRED FASTENERS TO SUPPORT THE 440 LBS WEIGHT CAPACITY**
 - **ANY ADDITIONAL MOUNTING SUPPORT**
 - **TRACK SUPPORT SHALL BE MOUNTED ACCORDING TO THE MANUAL SPECIFICATIONS**

- **WALL OR BASE CHASE INDICATED ON PAGE 6/KEYNOTE 4. THIS INCLUDES:**
 - **INSTALL WATER LINES/DRAINAGE LINES**
 - **FINISH TO MATCH EXISTING WALL TILE**

NOTE:

- **ANY DAMAGES DURING INSTALLATION SHALL BE REPAIRED AT THE EXPENSE OF THE CONTRACTOR**
- **POINT OF CONTACT SHALL BE NOTIFIED SHOULD ANY ADDITIONAL CHANGES ARE NEEDED OUTSIDE THE SCOPE OF WORK**
- **CONTRACTOR SHALL BE RESPONSIBLE FOR SUPPLYING ALL HARDWARE NEEDED FOR INSTALLS**

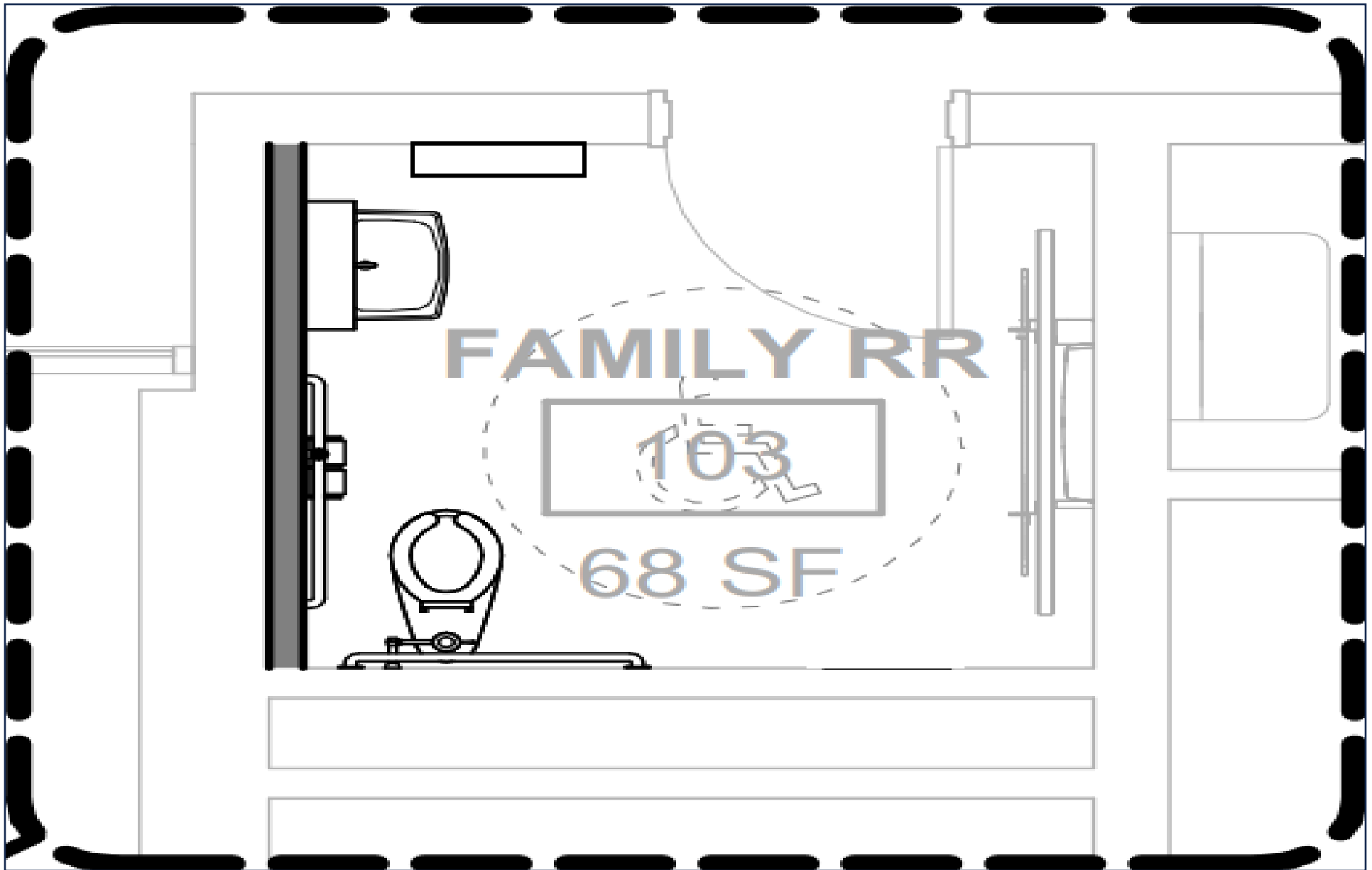

FINISHED LAYOUT

EQUIPMENT

- **COORDINATE WITH OWNER ON EQUIPMENT TO BE REMOVED, DISPOSED OF, OR SALVAGED.**
- **REPAIR EXISTING SPRAY APPLIED FIRE PROOFING DISTURBED AND/OR DAMAGED DURING CONSTRUCTION.**
- **THE INTEGRITY OF RELEVANT STRUCTURAL ELEMENTS SHALL BE MAINTAINED AT ALL TIMES THROUGHOUT DEMOLITION.**
- **CONTRACTOR IS RESPONSIBLE FOR SHORING AND TEMPORARY SUPPORT OF STRUCTURE NECESSARY DUE TO DEMOLITION.**

STRUCTURAL

- **REMOVE DEAD END PIPING AND CONDUIT (FOR EXAMPLE: RISERS WITH NO FLOW, BRANCHES WITH NO FIXTURE). EMPTY RISERS, MAINS, AND BRANCHES FOR FUTURE USE SHALL REMAIN.**
- **VOIDS RESULTING FROM MPE DEMOLITION IN WALL, FLOOR, OR CEILING ASSEMBLIES TO REMAIN SHALL BE PATCHED WITH SOLID MATERIALS MATCHING ADJACENT CONSTRUCTION.**
- **REPAIR EXISTING PIPE AND DUCT INSULATION DAMAGED DURING DEMOLITION.**
- **UTILITIES AND SYSTEMS IN AREAS OUTSIDE THE CONSTRUCTION LIMITS SHALL REMAIN (U.N.O.).**
- **WHERE SMOKE DETECTORS AND/OR DAMPERS LOCATED IN RATED ASSEMBLIES TO REMAIN ARE REMOVED DURING DEMOLITION, NEW SMOKE DAMPERS AND/OR DETECTORS, INCLUDING ALL ELECTRICAL WIRING, SHALL BE RE-INSTALLED AT NO COST.**
- **COORDINATE REQUIRED SHUTDOWNS OF BUILDING SYSTEMS WITH THE OWNER. SHUTDOWNS SHALL BE DONE AT TIMES MOST CONVENIENT TO THE BUILDING OPERATION, SOME OF WHICH MAY BE DURING NIGHTS OR WEEKENDS. OWNER WILL BE NOTIFIED OF ANY SHUTDOWNS TWO DAYS PRIOR.**

MPE SYSTEMS

- **COMPLY WITH REQUIREMENTS OF EPA, CODE OF FEDERAL REGULATIONS, NATIONAL EMISSIONS STANDARDS AND OSHA REGULATIONS ON HAZARDOUS MATERIALS AND ALL OTHER APPLICABLE FEDERAL, STATE AND LOCAL**
- **GOVERNMENT REGULATIONS WHICH ARE INCORPORATED BY REFERENCE.**
- **TDOT DOES NOT ANTICIPATE A NEED FOR REMOVAL OF HAZARDOUS MATERIALS, HOWEVER CONTRACTOR SHALL COORDINATE WITH OWNER ON RESPONSIBILITY OF REMOVAL OF HAZARDOUS MATERIALS SHOULD THE NEED BE IDENTIFIED DURING WORK.**
- **IF HAZARDOUS MATERIALS ARE SUSPECTED OR ENCOUNTERED, IMMEDIATELY SUSPEND WORK IN SUSPECTED AREA OF CONTAMINATION, WITHDRAW FROM AREA AND NOTIFY OWNER IN WRITING.**

HAZARDOUS MATERIALS

- DO NOT DISABLE OR DISRUPT BUILDING FIRE OR LIFE SAFETY SYSTEMS WITHOUT PRIOR WRITTEN NOTICE TO OWNER AND LOCAL AUTHORITY HAVING JURISDICTION (AHJ). PROVIDE A MINIMUM OF 3 DAYS NOTICE TO OWNER PRIOR TO DISRUPTION. COORDINATE WITH LOCAL AHJ REGARDING NOTICE REQUIREMENTS.
- ALL NECESSARY PATHS OF EGRESS AND EXITS SHALL BE MAINTAINED 'PROTECTED AND CLEAR' UNLESS ALTERNATE METHODS OF EGRESS ARE PROVIDED THAT ARE ACCEPTABLE TO BUILDING CODE OFFICIALS.
- RELOCATE SECURITY DEVICES, FIRE ALARM ITEMS, EXIT SIGNS, AND EMERGENCY LIGHTING AS REQUIRED DUE TO DEMOLITION OR OBSTRUCTION BY TEMPORARY PARTITIONS.

REGULATORY

- WHERE EXISTING CONSTRUCTION IS TO BE CUT OR REMOVED, PROVIDE SMOOTH AND STRAIGHT CUT JOINTS THAT ARE STRUCTURALLY SOUND. PATCH AND REPAIR ADJOINING SURFACES TO MATCH EXISTING AND PROVIDE IMPERCEPTIBLE TRANSITION, (U.N.O.)
- CEILINGS: REMOVE ENTIRE CEILING SYSTEM AND CEILING MOUNTED ITEMS. STORE DEVICES INTENDED FOR RE-USE.
- WALLS: REMOVE WALL COVERING SYSTEMS SUCH AS PANELING AND VINYL WALL COVERINGS. PATCH / REPAIR HOLES OR DAMAGED AREAS AND SKIM-COAT ENTIRE SURFACE.
- FLOORS: REMOVE FINISH TO SUB-FLOOR, CLEAN ADHESIVES AND GLUES FROM SUBSTRATE, AND PREPARE SUBSTRATE (LEVEL AND FILL AS NEEDED).

ARCHITECTURAL / INTERIORS

- WHERE NEW FINISHES ARE SCHEDULED IN EXISTING SPACES, COORDINATE WITH OWNER & REMOVE ALL OBSOLETE, UNNECESSARY, OR ABANDONED ITEMS IN DEMOLITION AREAS THAT ARE NOT APPROPRIATE TO REMAIN FOR NEW WORK.
- EXISTING CONDITIONS TO REMAIN: DAMAGED COMPONENTS SHALL BE REPAIRED BY THE CONTRACTOR AT NO COST TO THE OWNER. THIS INCLUDES DAMAGE DONE TO EXISTING SPACES ABOVE, BELOW, AND ADJACENT TO, AS REQUIRED TO COMPLETE NEW WORK.
- SURVEY EXISTING CONDITIONS AND CORRELATE WITH REQUIREMENTS INDICATED TO DETERMINE EXTENT OF SELECTIVE DEMOLITION REQUIRED. RECORD EXISTING CONDITIONS BY USE OF ANY COMBINATION OF MEASURED DRAWINGS AND PRECONSTRUCTION PHOTOGRAPHS.
- CEASE OPERATIONS IMMEDIATELY IF STRUCTURE APPEARS TO BE IN DANGER AND NOTIFY
- ARCHITECT/ENGINEER. DO NOT RESUME OPERATIONS UNTIL DIRECTED.

ARCHITECTURAL/INTERIORS CONT.

- **UTILITY SERVICE: MAINTAIN EXISTING UTILITIES INDICATED TO REMAIN IN SERVICE AND PROTECT THEM AGAINST DAMAGE DURING SELECTIVE DEMOLITION OPERATIONS. MAINTAIN FIRE-PROTECTION FACILITIES IN SERVICE DURING SELECTIVE DEMOLITION OPERATIONS.**
- **CONDUCT DEMOLITION TO MINIMIZE INTERFERENCE WITH OWNER'S NORMAL OPERATIONS AND WITH ADJACENT BUILDING AREAS.**
- **PROVIDE TEMPORARY DUST PARTITIONS, SECURITY DEVICES, AND OTHER MEANS NECESSARY FOR THE PROTECTION OF OCCUPANTS WHERE TRAFFIC IN CORRIDORS AND SPACES ADJACENT TO DEMOLITION / RENOVATION WORK ARE IMPACTED.**
- **CONTRACTOR TO MEET ALL FACILITY OR REGULATORY REQUIREMENTS RELATED TO PROTECTION OF OCCUPANTS.**

EXISTING CONDITIONS

- **REFER TO STRUCTURAL, MECHANICAL, PLUMBING, ELECTRICAL, AND VENDOR (IF APPLICABLE) DRAWINGS AND SPECIFICATIONS FOR ADDITIONAL DEMOLITION ITEMS AND INFORMATION.**
- **EXISTING WARRANTIES: REMOVE, REPLACE, PATCH, AND REPAIR MATERIALS AND SURFACES CUT OR DAMAGED DURING SELECTIVE DEMOLITION, BY METHODS AND WITH MATERIALS SO AS NOT TO VOID EXISTING... REMOVED & REINSTALLED ITEMS: CLEAN & REPAIR ITEMS TO FUNCTIONAL CONDITION ADEQUATE FOR INTENDED USE, PACK OR CRATE AFTER CLEANING / REPAIR AND IDENTIFY CONTENTS OF CONTAINERS,**
- **PROTECT ITEMS FROM DAMAGE DURING TRANSPORT / STORAGE, REINSTALL ITEMS IN LOCATIONS INDICATED.**
- **REMOVED & SALVAGED ITEMS: CLEAN ITEMS, PACK OR CRATE AFTER CLEANING AND IDENTIFY CONTENTS OF CONTAINERS, PROTECT AND TRANSPORT ITEMS TO OWNER'S STORAGE AREA ON-SITE.**
- **REMOVE CONSTRUCTION SHOWN DASHED ON DEMOLITION PLAN. REFERENCE LEGEND FOR MORE SPECIFIC INFORMATION.**
- **PRIOR TO START, HOLD A PRE-DEMOLITION CONFERENCE AT THE PROJECT SITE TO REVIEW METHODS AND PROCEDURES RELATED TO DEMOLITION. COORDINATE WITH OWNER REGARDING CONSTRUCTION ACCESS,**
- **TRANSPORTATION AND DISPOSAL OF DEBRIS, AND OTHER FACILITY REQUIREMENTS RELATED TO CONSTRUCTION.**
- **COORDINATE SCOPE OF DEMOLITION WORK TO INSTALL NEW WORK SHOWN ELSEWHERE IN THE CONTRACT**
- **DOCUMENTS. (FOR EXAMPLE, IF NEW FINISHES ARE SCHEDULED FOR AN EXISTING AREA TO REMAIN, REMOVE EXISTING FINISHES PRIOR TO INSTALLATION OF NEW FINISHES EVEN IF NOT EXPLICITLY IDENTIFIED ON DEMOLITION PLAN.)**
- **INSTALLATION**
 - **DOOR SHALL HAVE AN OVERHEAD STOP ADJUSTED TO STOP BEFORE IT WOULD HIT THE CHANGING STATION.**

SPECIFICATIONS CONT.

EXISTING CONDITIONS CONT.

- **MATCH EXISTING TILE PATTERN**
- **A POWER SOURCE WILL BE REQUIRED TO OPERATE THE CHANGING TABLE. CLOSEST**
- **OUTLET SHALL BE LOCATED ON THE SITE AND POWER PULLED TO THE TABLE.**
- **ADULT CHANGING TABLE. BASIS OF DESIGN.**
- **REFER TO INSTALLATION MANUAL FOR TYPES OF FASTNERS REQUIRED FOR ATTACHMENT TO WOOD, EMPTY/POURED CONCRETE BLOCK.**

SPECIFICATIONS CONT.

ELECTRIC POWERED ADULT WALL MOUNTED CHANGING TABLE

ACCEPTABLE BRANDS/MODELS: ASTOR BANNERMAN INVINCIBLE, PRESSALIT CT4000 VERSAMAX, OR EQUAL*

SPECIFICATIONS:

WORKING LOAD: MINIMUM 440 POUNDS

TOTAL MAXIMUM WIDTH SHALL NOT EXCEED 41" FROM WALL WHEN TABLE/STRETCHER IS DEPLOYED

TABLE/STRETCHER DIMENSIONS:

- **LENGTH: MINIMUM 70" – MAXIMUM 72"**
- **WIDTH: MINIMUM 30" – MAXIMUM 32"**

TABLE/STRETCHER SURFACE TO BE DESIGNED FOR EASY CLEAN-UP.

ADJUSTABLE HEIGHT RANGE OF 12" FROM FLOOR TO 39" FROM FLOOR

TABLE/STRETCHER TO MANUALLY FOLD UP WHEN NOT IN USE.

FOLD DOWN SAFETY RAIL ON FRONT OF TABLE/STRETCHER.

INTEGRATED FRONT CONTROL PANEL FOR RAISING AND LOWERING TABLE/STRETCHER.

ELECTRICAL REQUIREMENT: 120 VOLT

***IF BIDDING AN EQUAL BRAND PLEASE SUBMIT LITERATURE THAT SUBSTANTIATES THE ITEM BID MEETS SPECIFICATIONS.**

TABLE SPECIFICATIONS

