

WASTEWATER TREATMENT SYSTEM IMPROVEMENTS

CITY OF MCKENZIE, TENNESSEE

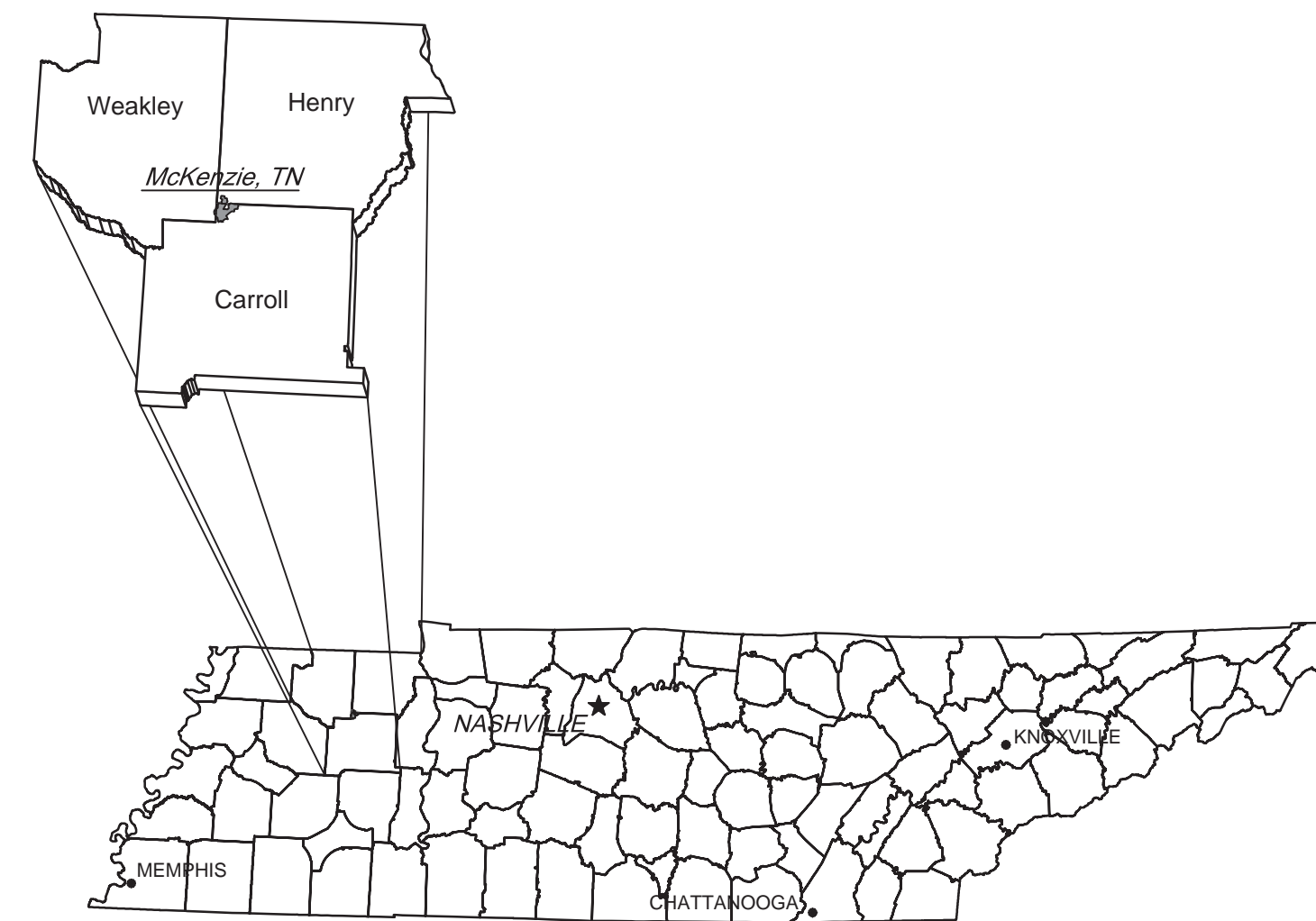

DWG. No.	INDEX OF DRAWINGS
G-01	PROJECT LOCATION MAP AND GENERAL NOTES
C-02	EXISTING PLANT LAYOUT AND PROPOSED MODIFICATIONS
C-03	PRETREATMENT UNIT - PROPOSED MODIFICATIONS
C-04	BLOWER PAD - PROPOSED MODIFICATIONS



engineering | architecture | geospatial

www.grwinc.com



MARCH 2024



GRW PROJECT NO. 3849-16

PLOTTED BY: bhholland

PRINTED: 3/26/2024 @ 8:30AM

FILE NAME: G:\3849-McKenzie\16-McK-ARPA-STP\Working Drawings\AutoCAD\3849_16_G-01.dwg

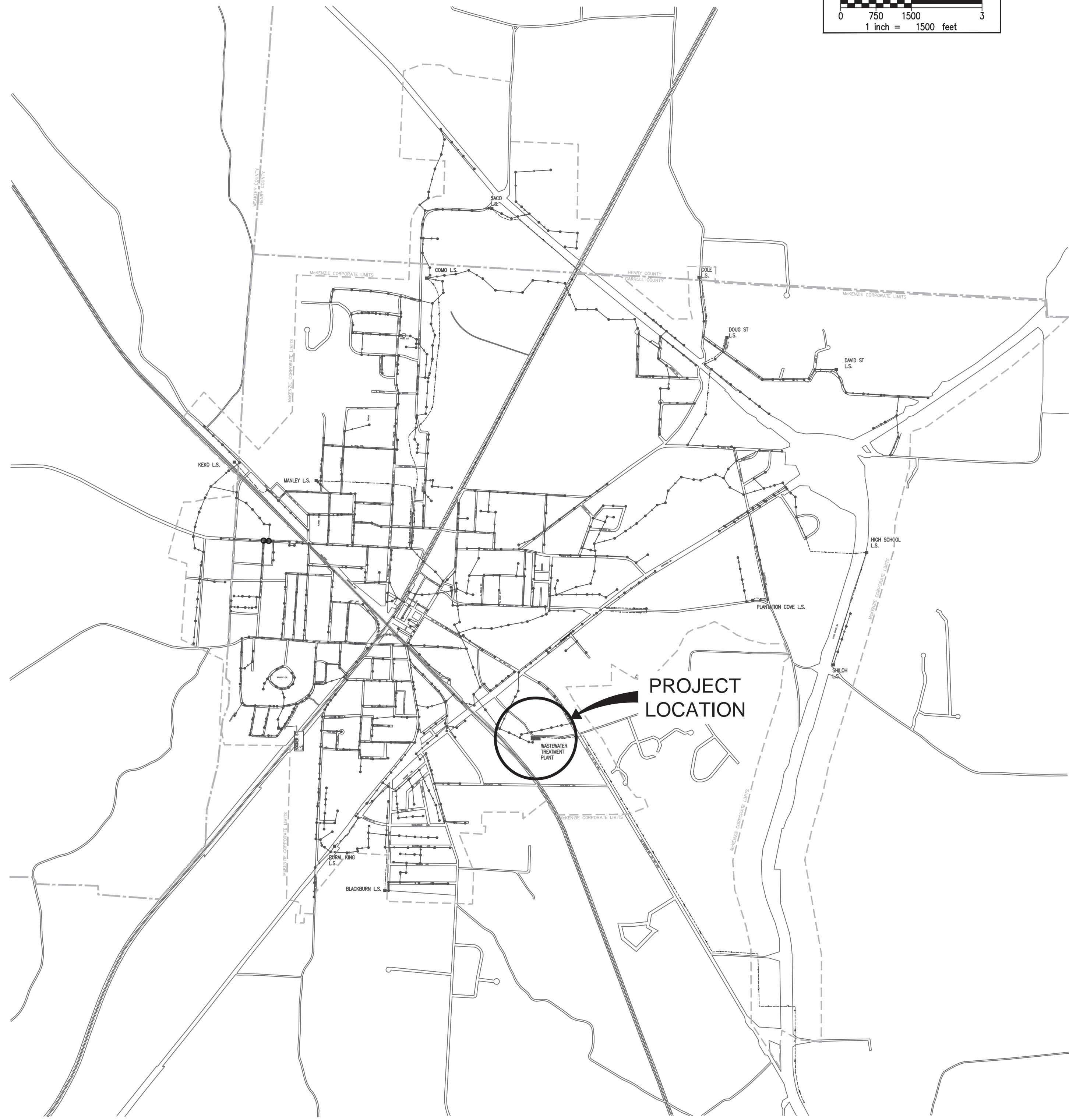
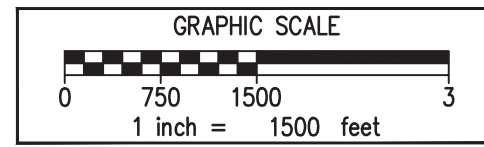

McKENZIE, TENNESSEE

PROJECT LOCATION – SHEET LAYOUT PLAN

GENERAL NOTES

1. THE CONTRACTOR SHALL RESTORE ALL CULVERTS, FENCES, WALLS, SMALL ORNAMENTAL TREES, CULTIVATED SHRUBS, FLOWERS, SIGNS, LIGHTS AND POWER POLES, STREET MARKERS, MAIL BOXES, WATER AND GAS LINES, WATER AND GAS METERS AND BOXES INCLUDING SHUT-OFFS, AND LAWNS DISTURBED BY CONSTRUCTION OPERATIONS TO THEIR ORIGINAL CONDITIONS. THE COST OF THIS WORK SHALL BE MERGED IN THE UNIT BID AND CONTRACT PRICES FOR THE PROPOSED WORK.
2. WHERE IN EASEMENTS THE CONTRACTOR SHALL PROTECT AND RESTORE SAID PROPERTY TO CONDITION SIMILAR OR EQUAL TO THAT EXISTING AT THE COMMENCEMENT OF CONSTRUCTION, EXCEPT AS NOTED.
3. THE LOCATION OF EXISTING UNDERGROUND UTILITIES ARE SHOWN IN AN APPROXIMATE WAY ONLY. THE CONTRACTOR SHALL DETERMINE THE EXACT LOCATION OF ALL EXISTING UTILITIES BEFORE COMMENCING WORK IN EACH AREA. HE AGREES TO BE FULLY RESPONSIBLE FOR ANY AND ALL DAMAGES WHICH MIGHT BE CAUSED BY HIS FAILURE TO EXACTLY LOCATE AND PRESERVE ANY AND ALL UTILITIES. BEFORE CONSTRUCTION, CONTRACTOR SHALL CONTACT :

TENNESSEE811
DIAL 811 (OR 1-800-351-1111)
72 HOURS NOTICE
4. CONTRACTOR SHALL NOT PLACE ANY VALVES OR OTHER ABOVE GRADE DEVICES IN ANY DITCH LINE ON STATE HIGHWAY RIGHT OF WAY.
5. IF ANY EXISTING STORM SEWERS ARE SUBSTANTIALLY DAMAGED AS DETERMINED BY THE A/E AND OR OWNER, THE REPAIR SHALL BE MADE WITH R.C.P. PIPE FROM STRUCTURE-TO-STRUCTURE. PIPE SIZE SHALL BE EQUAL TO EXISTING.
6. SUFFICIENT PRECAUTIONS SHALL BE TAKEN DURING CONSTRUCTION TO MINIMIZE THE RUN-OFF OF POLLUTING SUBSTANCES SUCH AS SILT, CLAY, FUELS, OILS, BITUMENS, CALCIUM CHLORIDE, OR OTHER POLLUTING MATERIALS HARMFUL TO HUMANS, FISH OR OTHER LIFE, INTO THE SUPPLIES AND SURFACE WATERS OF THE STATE. CONTROL MEASURES MUST BE ADEQUATE TO ASSURE THAT LOCAL, STATE AND FEDERAL LAWS AND REGULATIONS ARE MET. THE CONTRACTOR IS SOLELY RESPONSIBLE FOR ENSURING THAT THE LAWS AND REGULATIONS ARE MET AND IS RESPONSIBLE FOR ENSURING THAT CONSTRUCTION DOES NOT HARM THE WATERS OF TENNESSEE. THE PROTECTION OF THE SITE SHALL CONTINUE THROUGHOUT THE CONSTRUCTION PERIOD. SPECIAL PRECAUTIONS SHALL BE TAKEN IN THE USE OF CONSTRUCTION EQUIPMENT TO PREVENT OPERATIONS WHICH PROMOTE EROSION.
7. THE TEMPORARY POLLUTION CONTROL PROVISIONS SHALL BE COORDINATED WITH THE PERMANENT EROSION CONTROL MEASURES, TO ENSURE ECONOMICAL, EFFECTIVE, AND CONTINUOUS EROSION CONTROL THROUGHOUT THE CONSTRUCTION AND POST-CONSTRUCTION PERIOD OF THE PROJECT. NATURAL COVER SHOULD BE MAINTAINED AS LONG AS POSSIBLE AND GRADED AREAS SHOULD BE STABILIZED AS SOON AS POSSIBLE.
8. THE CONTRACTOR SHALL OBTAIN ALL PERMITS FROM THE APPROPRIATE FEDERAL, STATE, COUNTY AND/OR LOCAL AGENCIES TO CROSS ALL HIGHWAYS, STREETS, STREAMS, EASEMENTS, ETC...
9. STATE HIGHWAY RIGHT-OF-WAY INFORMATION PROVIDED BY THE STATE OF TENNESSEE DEPARTMENT OF TRANSPORTATION. QUESTIONS CONCERNING R-O-W LOCATION ON ANY STATE HIGHWAY SHOULD BE REFERRED TO THE APPROPRIATE REGIONAL OFFICE OF THE STATE OF TENNESSEE DEPARTMENT OF TRANSPORTATION.
10. PROPERTY OWNERS AND PARCEL INFORMATION PROVIDED BY THE COUNTY REGISTRAR OF DEEDS.
11. COUNTY ROAD RIGHT-OF-WAY INFORMATION PROVIDED BY THE COUNTY HIGHWAY DEPT. QUESTIONS CONCERNING R-O-W LOCATION ON ANY COUNTY ROAD SHOULD BE REFERRED TO THE COUNTY HIGHWAY DEPARTMENT.
12. LOCATION AND REFERENCE OF MANHOLES AND SEWERS HAVE BEEN APPROXIMATED FROM EXISTING PLANS OR RECORD DRAWINGS. THE CONTRACTOR SHALL VERIFY EXACT LOCATIONS AND LINE SIZE, MATERIAL, ETC.
13. EXISTING SANITARY SEWER MAPS PROVIDED BY CITY OF MCKENZIE, TN



GRW PROJECT NO. 3849-16



**PROJECT LOCATION MAO AND GENERAL NOTES
WASTEWATER TREATMENT SYSTEM IMPROVEMENTS
CITY OF MCKENZIE, TENNESSEE**

DESIGNED	RG
DRAWN	BH
REVIEWED	RG
APPROVED	RG

NO.	DATE	DESCRIPTION	BY

DATE: MARCH, 2024
SCALE: 1" = 1500'
SHEET NO.

G-01

CONTRACT DOCUMENTS

PLOTTED BY: bhholland

PRINTED: 3/26/2024 @ 8:30AM

FILE NAME: C:\3849-McKenzie\16-Mck-ARPA-STP\Working Drawings\AutoCAD\3849_16_C-02.dwg



GRW PROJECT NO. 3849-16

ALL RIGHTS RESERVED. THE CONTENTS OF THIS DRAWING ARE THE PROPERTY OF GRW ENGINEERS, INC. AND SHALL NOT BE REPRODUCED IN WHOLE OR IN PART WITHOUT THE WRITTEN PERMISSION OF GRW ENGINEERS, INC.



EXISTING PLANT LAYOUT AND PROPOSED MODIFICATIONS

WASTEWATER TREATMENT SYSTEM IMPROVEMENTS

CITY OF MCKENZIE, TENNESSEE

DESIGNED	RGT
DRAWN	BHH
REVIEWED	RGT
APPROVED	RGT

NO.	REVISIONS DESCRIPTION	DATE	BY

DATE: MARCH, 2024
SCALE: NOT TO SCALE
SHEET NO.

C-02

CONTRACT DOCUMENTS

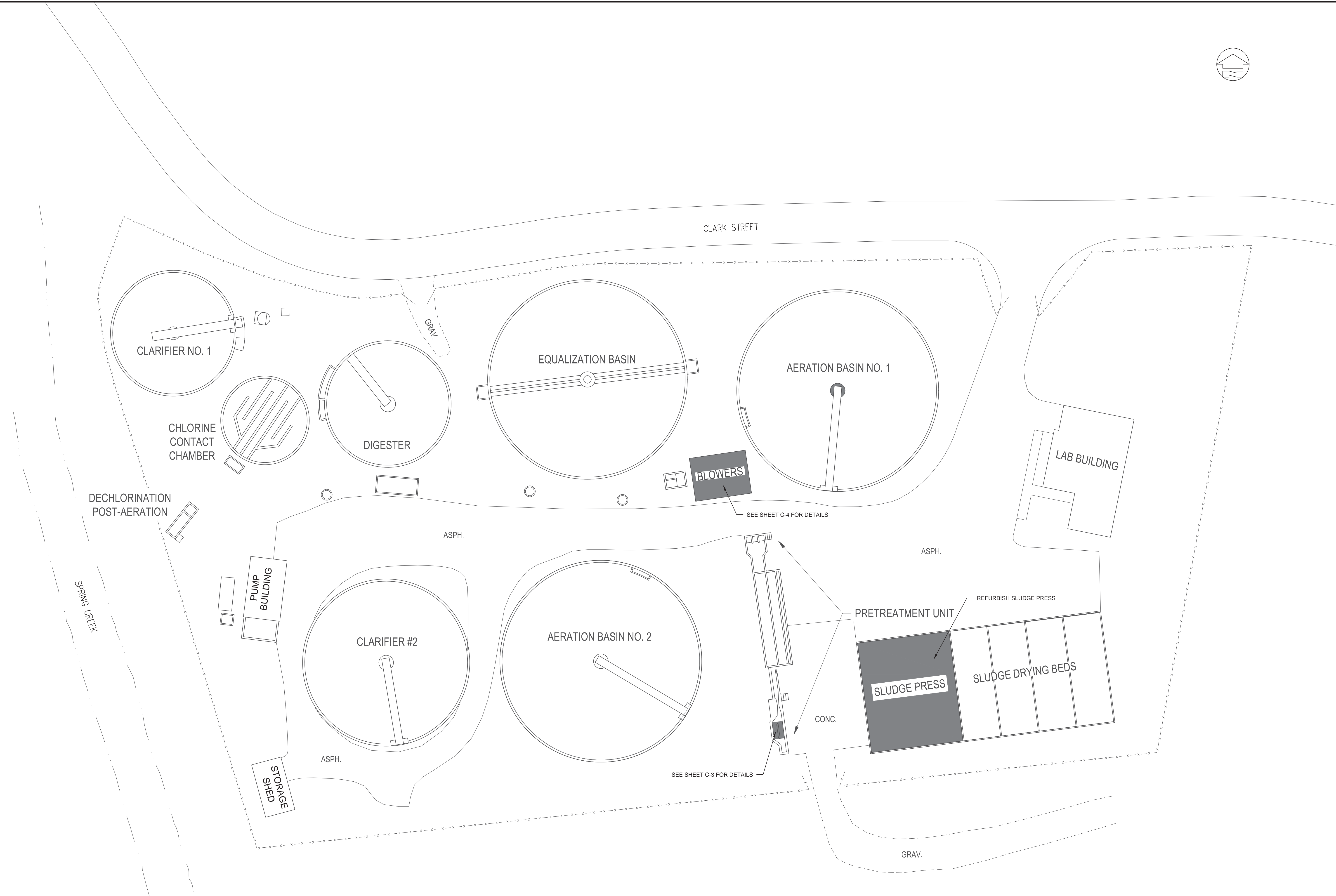

EXISTING PLANT LAYOUT AND PROPOSED MODIFICATIONS

NOT TO SCALE

- LEGEND:**
- STRUCTURE/EQUIPMENT TO REPLACE
 - STRUCTURE/EQUIPMENT TO BE REPAIRED
 - STRUCTURE/EQUIPMENT TO BE CLEANED OUT

PLOTTED BY: bhholland

PRINTED: 3/26/2024 @ 8:30AM

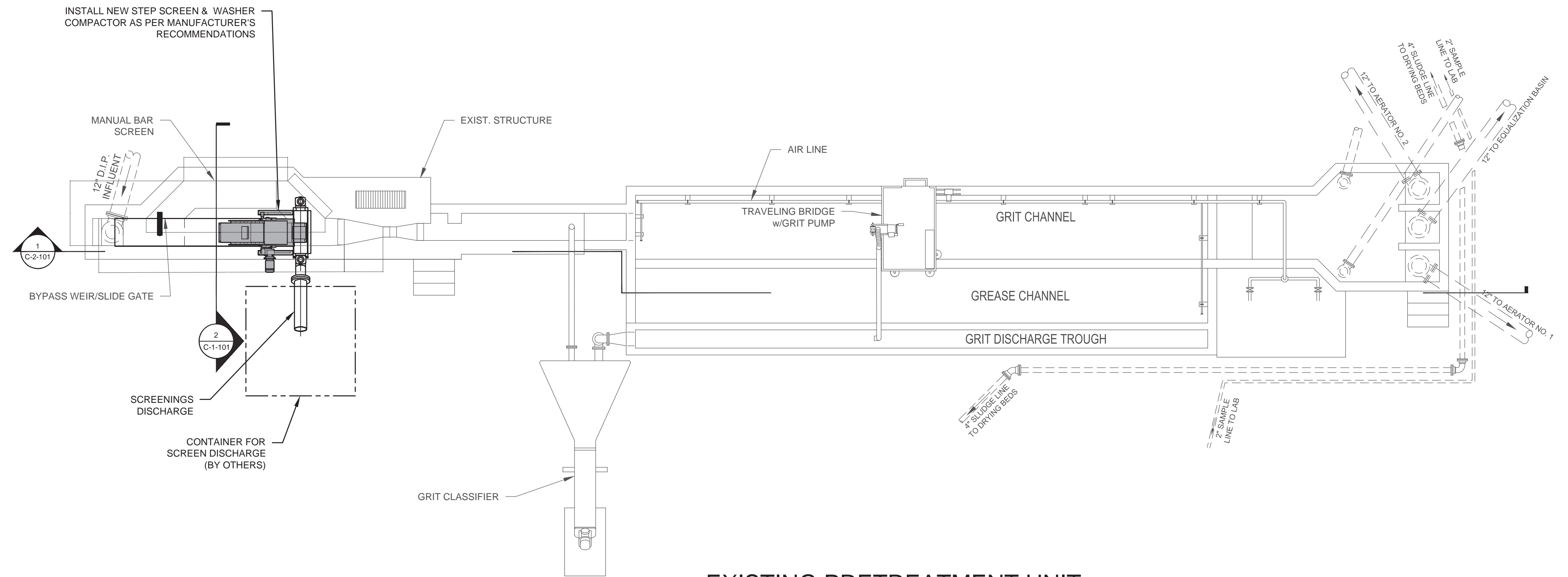

FILE NAME: C:\3849-McKenzie\16-Mck-ARPA-STP\Working Drawings\AutoCAD\3849_16_C-03.dwg



**EXISTING PRETREATMENT UNIT
PROPOSED MODIFICATIONS - PLAN VIEW**

NOT TO SCALE

LEGEND

-  DEMOLISH / REMOVE / REPLACE
-  NEW / PROPOSED
-  EXIST. STRUCTURE / EQUIPMENT

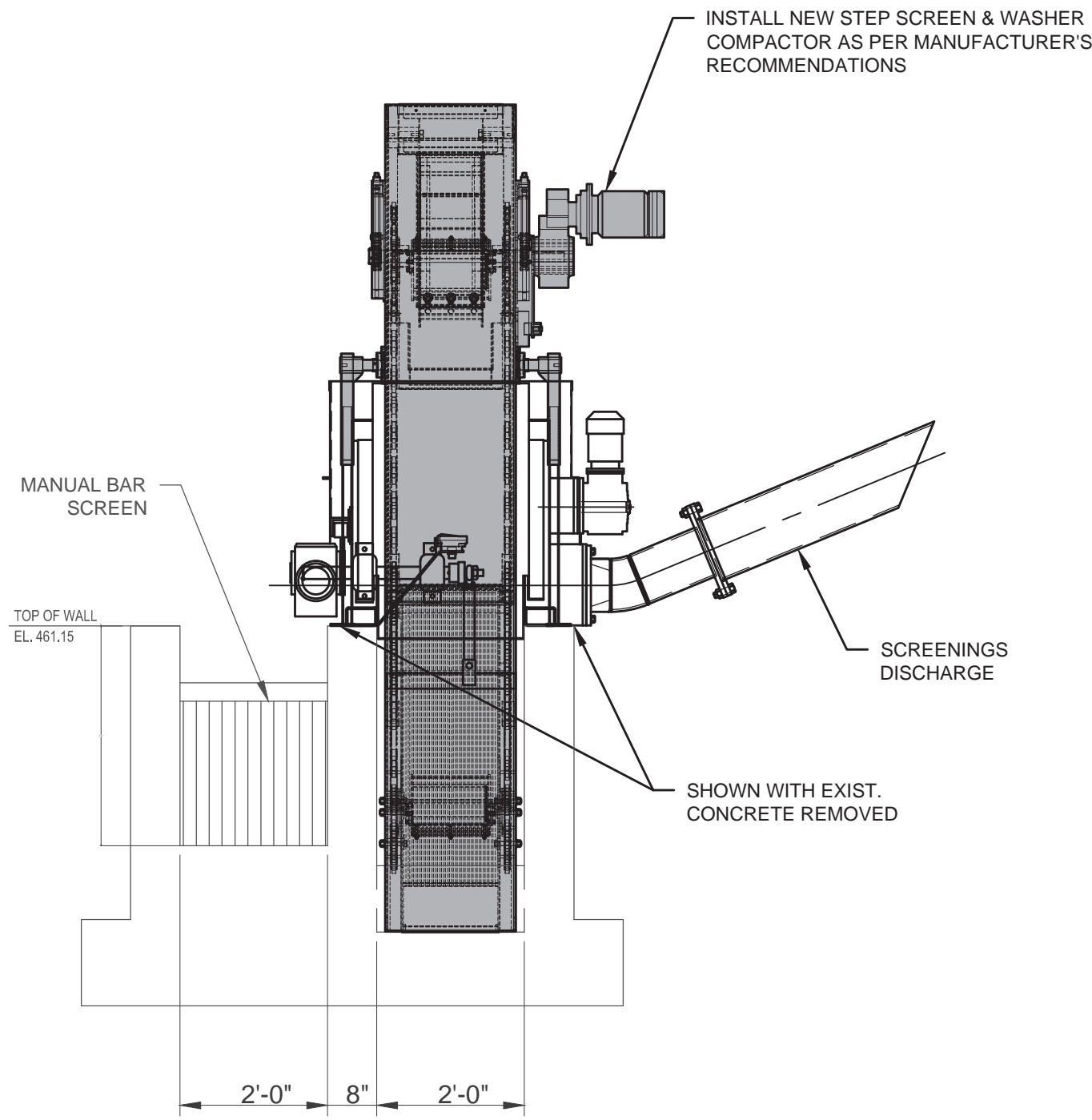

**PRE-TREATMENT UNIT
SECTION 2 VIEW**

SCALE: 1/2"=1'-0"

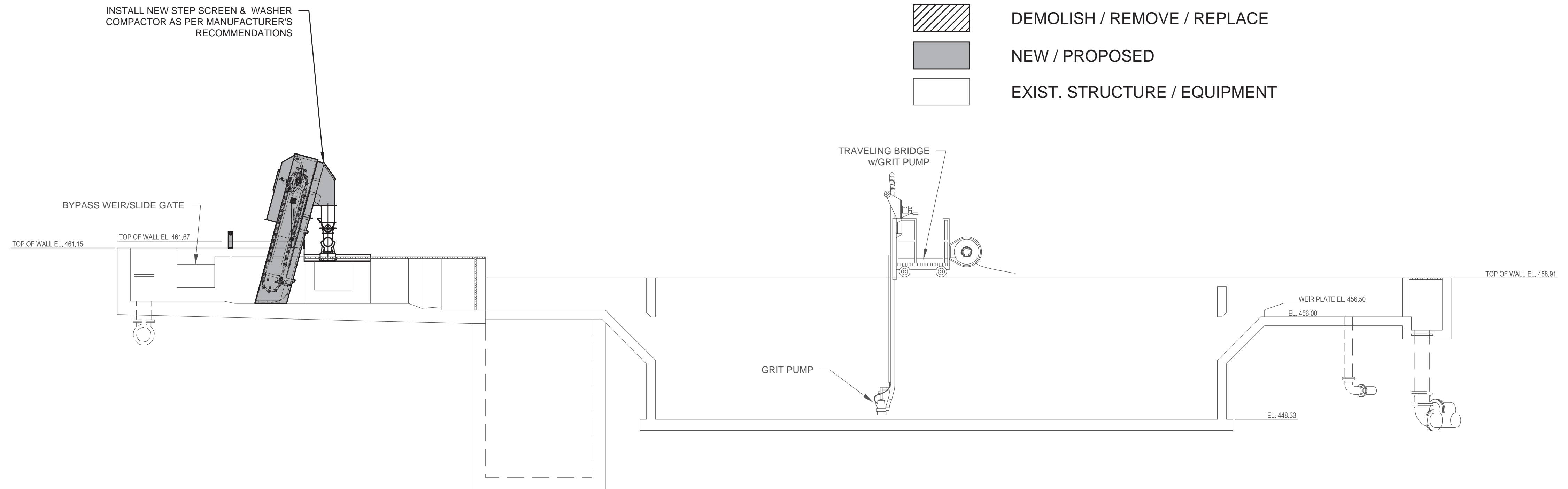

1 SECTION

NOT TO SCALE

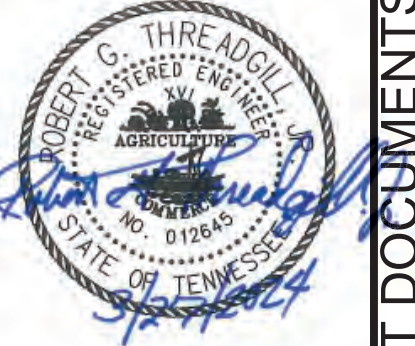

GRW PROJECT NO. 3849-16



**PRETREATMENT UNIT
PROPOSED MODIFICATIONS
WASTEWATER TREATMENT SYSTEM IMPROVEMENTS
CITY OF MCKENZIE, TENNESSEE**

DESIGNER	RG	RG	RG	RG
DATE	BY	DATE	BY	DATE

DATE: MARCH, 2024
SCALE: NOT TO SCALE
SHEET NO.

C-03

CONTRACT DOCUMENTS



GRW PROJECT NO. 3849-16
 ALL RIGHTS RESERVED. NO PART OF THIS DRAWING OR ANY INFORMATION CONTAINED HEREIN SHALL BE REPRODUCED IN WHOLE OR IN PART WITHOUT THE WRITTEN PERMISSION OF GRW ENGINEERS, INC. AND SHALL NOT BE USED FOR ANY OTHER PROJECT OTHER THAN THIS SPECIFIC PROJECT WITHOUT THE WRITTEN PERMISSION.



**BLOWER PAD
 PROPOSED MODIFICATIONS**
 WASTEWATER TREATMENT SYSTEM IMPROVEMENTS
 CITY OF MCKENZIE, TENNESSEE

DESIGNED: RGT
 DRAWN: BHH
 REVIEWED: RGT
 APPROVED: RGT

NO.	DATE	DESCRIPTION

SCALE CHECK: THIS MARK SHOULD MEASURE EXACTLY 1" WHEN PLOTTED

DATE: MARCH, 2024
 SCALE: NOT TO SCALE
 SHEET NO.

NOTE CONTRACTOR IS RESPONSIBLE FOR LOCATING AND REPAIRING/REPLACING THE 4 DAMAGED BLOWERS

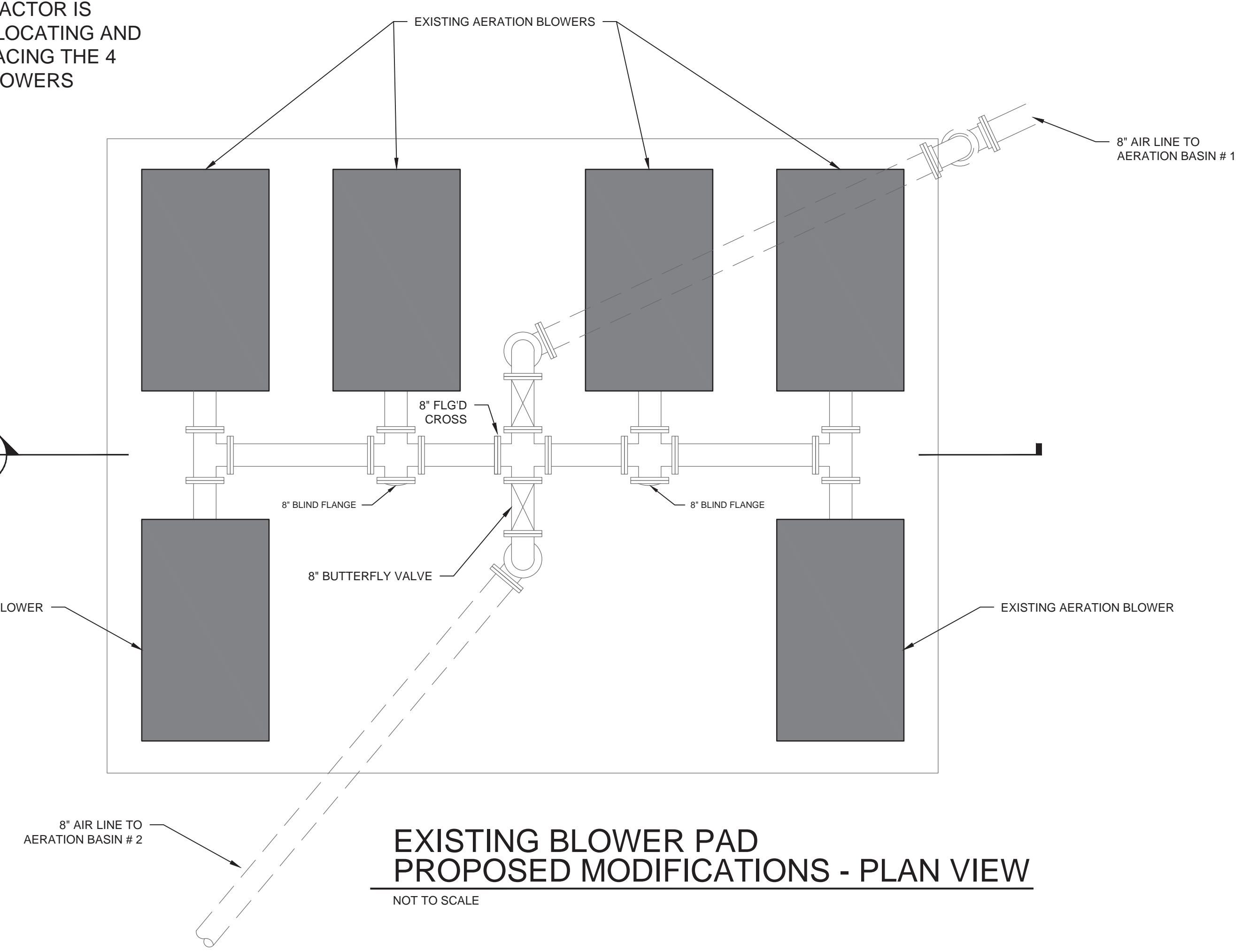
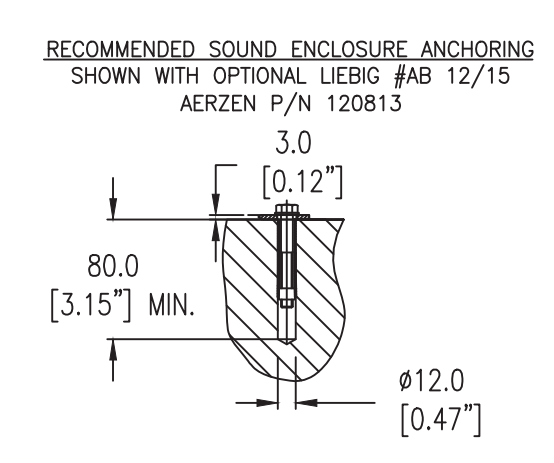
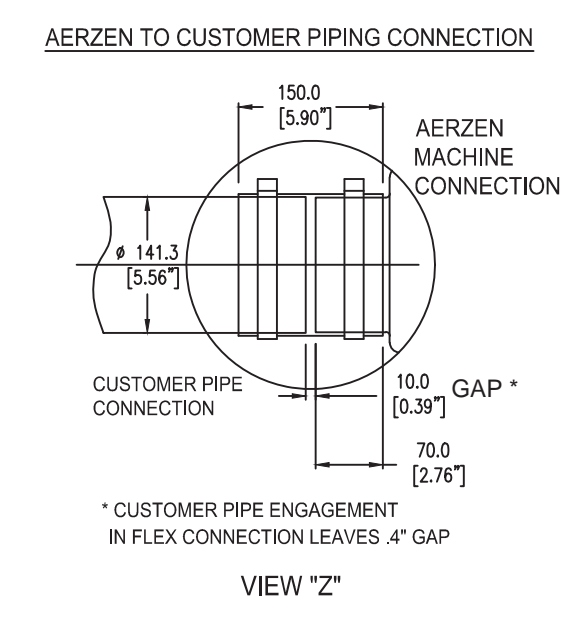
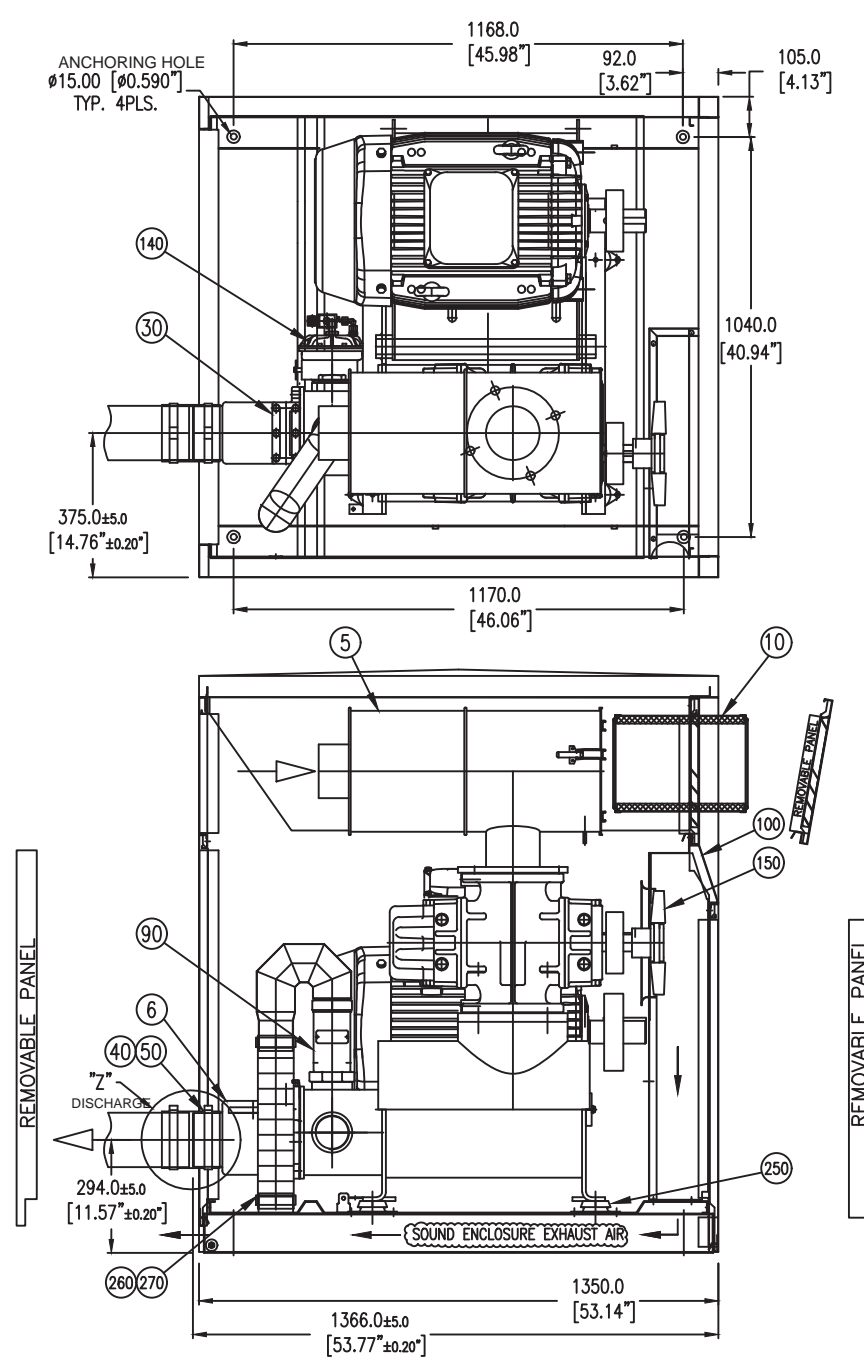

**EXISTING BLOWER PAD
 PROPOSED MODIFICATIONS - PLAN VIEW**
 NOT TO SCALE

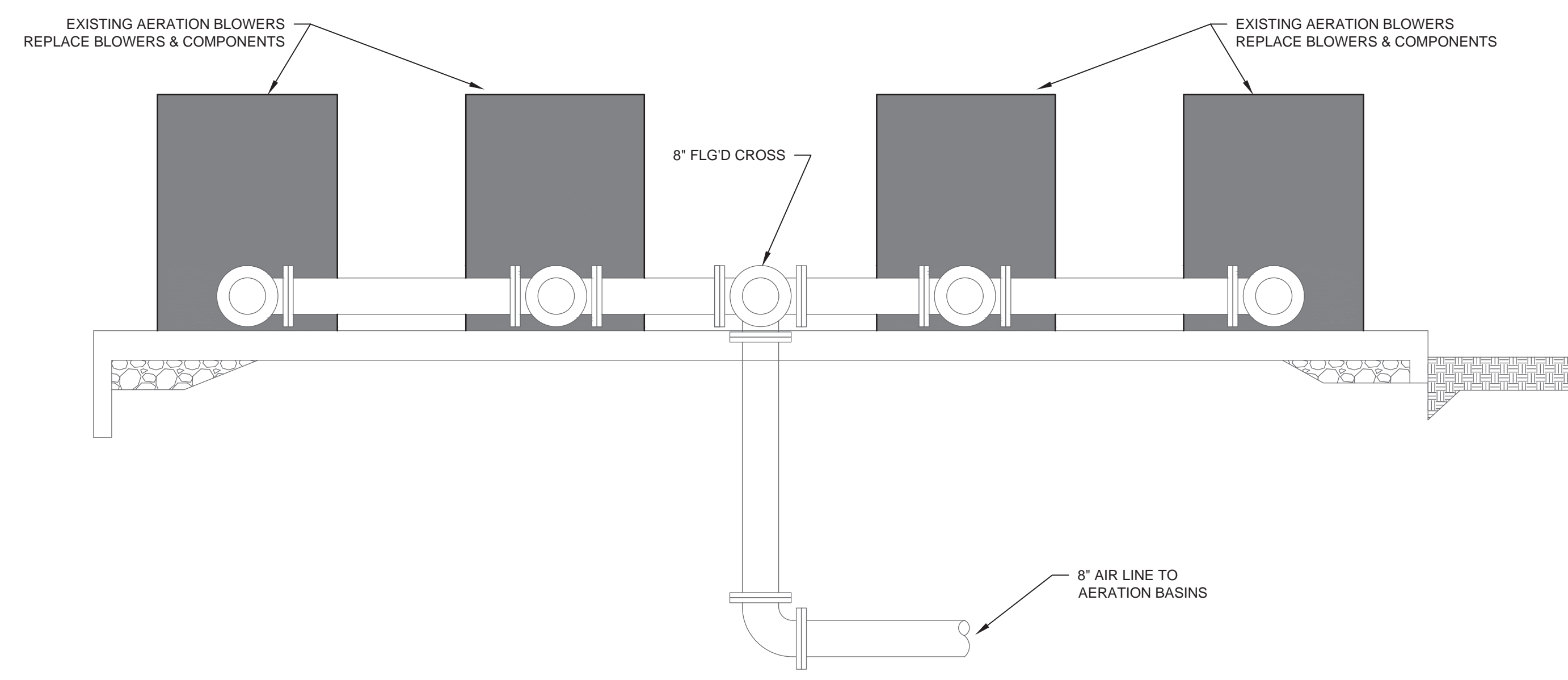

1 SECTION
 NOT TO SCALE

LEGEND:
 ■ STRUCTURE/EQUIPMENT TO REPLACE

ITEM	QTY.	DESCRIPTION
1	1	BLOWER
2	1	MOTOR, SHOWN WITH WEG 365T-F3 FRAME
3	1	BASE FRAME
4	1	SOUND ENCLOSURE (S.E.)
5	1	INLET FILTER/SILENCER ASSEMBLY
6	1	DISCHARGE HOUSING
10	1	INLET FILTER ELEMENT (SHOWN REMOVED)
20	-	DRIVE BELTS (SEE JOB SPECIFIC DATA)
30	1	ONE-WAY VALVE
40	1	FLEXIBLE CONNECTOR (DISCHARGE)
50	2	CLAMPS FOR DISCHARGE FLEX CONNECTOR
90	1	SAFETY RELIEF VALVE
100	-	INSTRUMENTATION (SEE JOB SPECIFIC DATA)
140	1	UNLOADING VALVE (OPTIONAL)
150	1	S.E. VENTILATION FAN (MOUNTED ON BLOWER SHAFT)
170	1	MOTOR SHEAVE BUSHING
180	1	MOTOR SHEAVE
190	1	BLOWER SHEAVE BUSHING
200	1	BLOWER SHEAVE
250	-	VIBRATION ISOLATORS (SEE JOB SPECIFIC DATA)
260	1	SAFETY RELIEF VALVE HOSE
270	2	SAFETY RELIEF VALVE HOSE CLAMPS

- NOTES**
- TOLERANCE ON DIMENSIONS = ±12mm [0.5"]
 - WEIGHT: BLOWER PACKAGE WEIGHT 555 Kg (1221 Lbs.)
 MOTOR WEIGHT
 TOTAL
 - REMOVABLE PANEL WEIGHT:
 PANELS DO NOT EXCEED APPROX. 18 Kg (40 Lbs)
 - CUSTOMER PIPING TO BE INDEPENDENTLY SUPPORTED
 - LIFTING OF PACKAGE: AFTER REMOVING FRONT & REAR DOORS, FROM FRONT SIDE THROUGH FORK LIFT POCKET IN BASE
 - FREE SPACE FOR MAINTENANCE WORK AT FRONT AND REAR SIDE OF UNIT APPROX. 800mm [32"]
 - FOR ADDITIONAL INFORMATION SEE: JOB SPECIFIC DATA PACKAGE

PLOTTED BY: bholland

PRINTED: 3/26/2024 @ 8:31AM

FILE NAME: C:\3849-Mckenzie\16-Mck ARPA STP\Working Drawings\AutoCAD\3849_16_C-04.dwg