

**WALL LEGEND**

WALL PARTITION - MTL STUD WALL

- BRACE ALL METAL STUD WALLS TO STRUCTURE ABOVE @ 4'-0" O.C. MINIMUM.
- SEE INTERIOR WALL TYPES SHEET ON A001 FOR MORE INFORMATION
- INTERIOR WALLS ARE TYPE S-3-0 UNLESS OTHERWISE NOTED

**WALL TYPE TAG**

WALL TYPE ID:  $\frac{SD}{2} \frac{10}{1} A$  CORE THICKNESS: 10  
 FIRE RATING: 2 ADDITIONAL COMPONENTS: A

**OVERALL FLOOR PLAN**  
 SCALE: 3/16" = 1'-0"



MBI COMPANIES INC.  
 UNIVERSITY TOWER  
 651 E. FOURTH STREET, SUITE 500  
 CHATTANOOGA, TN 37403  
 PHONE: (423) 756-6046  
 FAX: (423) 756-8021  
 WEB: mbicompanies.com

**CONSULTANT**

SEAL



COPYRIGHT © MBI COMPANIES INC. 2001  
 THE DESIGN PROFESSIONAL DENIES ANY AND ALL RESPONSIBILITY AND LIABILITY FOR PROBLEMS WHICH ARISE FROM FAILURE TO FOLLOW THESE PLANS, SPECIFICATIONS AND THE DESIGN INTENT THEY CONVEY, OR PROBLEMS WHICH ARISE FROM OTHER FAILURE TO OBTAIN AND/OR FOLLOW THE DESIGN PROFESSIONAL'S GUIDANCE WITH RESPECT TO ANY ERRORS, OMISSIONS, INCONSISTENCIES, AMBIGUITIES OR CONFLICTS WHICH ARE ALLEGED.

**PROJECT INFORMATION**

PROJECT: RHEA COUNTY HEALTH DEPARTMENT RENOVATION  
 PROJECT ADDRESS: 334 EAGLE LANE, EVANSVILLE, TN 37332  
 PROJECT NO.: 231401

**NOTES**

**ACTIVE DESIGN PHASE**

<input type="checkbox"/>	FOR REVIEW ONLY
<input type="checkbox"/>	FOR PERMITTING ONLY
<input type="checkbox"/>	SCHEMATIC DESIGN
<input type="checkbox"/>	DESIGN DEVELOPMENT
<input type="checkbox"/>	CONSTRUCTION BIDDING
<input checked="" type="checkbox"/>	CONSTRUCTION DOCUMENTS
<input type="checkbox"/>	AS-BUILT RECORD SET

**REVISION INFORMATION**

NO.	DATE	DESCRIPTION

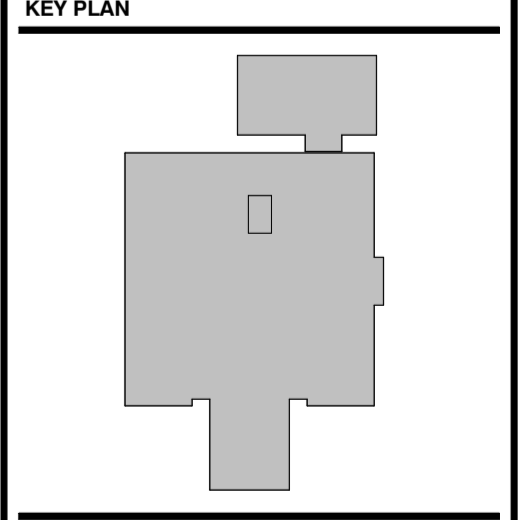

**SHEET INFORMATION**

SHEET ISSUED:	05/31/2024
DESIGNED BY:	T.J.H.
DRAWN BY:	T.J.H.
REVIEWED BY:	J.A.I.
SHEET TITLE:	OVERALL FLOOR PLAN

OVERALL FLOOR PLAN  
 SHEET NO.: A101

Autodesk Docs (231401) - Rhea County Health Department(231401) - bldg\_L023.rvt 5/31/2024 11:26:29 AM