

**Henderson Industrial Park Phase III  
Clearing and Grading  
The City of Henderson, Tennessee  
TLM Job No.: J-7056**

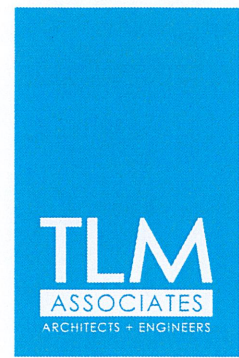

**ADDENDUM NO.: 1**

07/18/2024

This Addendum shall apply to the Drawings and Specifications for the above-referenced project and shall be bound into and made a part of the Construction Documents issued by TLM Associates, Inc., titled as indicated above.

- Item No. 1:**     **DRAWING SHEET C2.0** – Replace this sheet with C2.0 – Revision 1, **attached** herein. The proposed grading has been revised with the intent of balancing cut and fill. Revised endwall note to include the slope of endwall.
  
- Item No. 2:**     **DRAWING SHEET C3.0** – Replace this sheet with C3.0 – Revision 1, **attached** herein. Adjusted the silt fence for grading revision.
  
- Item No. 3:**     **DRAWING SHEET C3.1** – Replace this sheet with C3.1 – Revision 1, **attached** herein. Adjusted the silt fence for grading revision.
  
- Item No 4:**     **DRAWING SHEET C3.2** – Replace this sheet with C3.2 – Revision 1, **attached** herein. Adjusted the silt fence for grading revision.
  
- Item No. 5:**     **DRAWING SHEET C3.3** – Replace this sheet with C3.3 – Revision 1, **attached** herein. Revised stabilization plan for grading revision.

Please acknowledge receipt of this Addendum in the appropriate location on the Bid Form.

Sincerely,

TLM ASSOCIATES, INC.  
*Architects + Engineers*



Bob Safin, P.E.  
Project Manager



| REVISIONS |                                 |
|-----------|---------------------------------|
| NO.       | DESCRIPTION                     |
| 1         | REVISION FOR GRADING ALLOCATION |
| 2         | REVISION FOR GRADING ALLOCATION |
| 3         | REVISION FOR GRADING ALLOCATION |
| 4         | REVISION FOR GRADING ALLOCATION |
| 5         | REVISION FOR GRADING ALLOCATION |
| 6         | REVISION FOR GRADING ALLOCATION |
| 7         | REVISION FOR GRADING ALLOCATION |
| 8         | REVISION FOR GRADING ALLOCATION |
| 9         | REVISION FOR GRADING ALLOCATION |
| 10        | REVISION FOR GRADING ALLOCATION |

| CONSULTANT |    |
|------------|----|
| DATE       | BY |
| 2024.07.17 | TS |
| 2024.07.17 | TS |
| 2024.07.17 | TS |
| 2024.07.17 | TS |
| 2024.07.17 | TS |
| 2024.07.17 | TS |
| 2024.07.17 | TS |
| 2024.07.17 | TS |
| 2024.07.17 | TS |

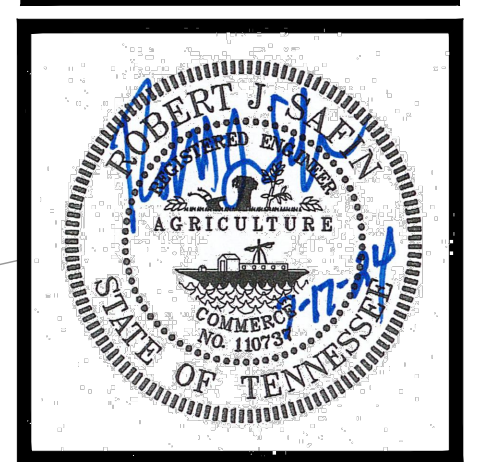

**TLM ASSOCIATES, INC.**  
ARCHITECTS + ENGINEERS  
www.tlma.com  
117 East Lafayette Street Jackson, Tennessee 38301  
731.988.9840 (phone) 731.988.9959 (fax)

**GRADING PLAN**  
**HENDERSON INDUSTRIAL PARK PHASE III**  
Clearing and Grading  
for  
City of Henderson  
Chester County, Tennessee

Jun 25, 2024  
J-7056  
**C2.0**

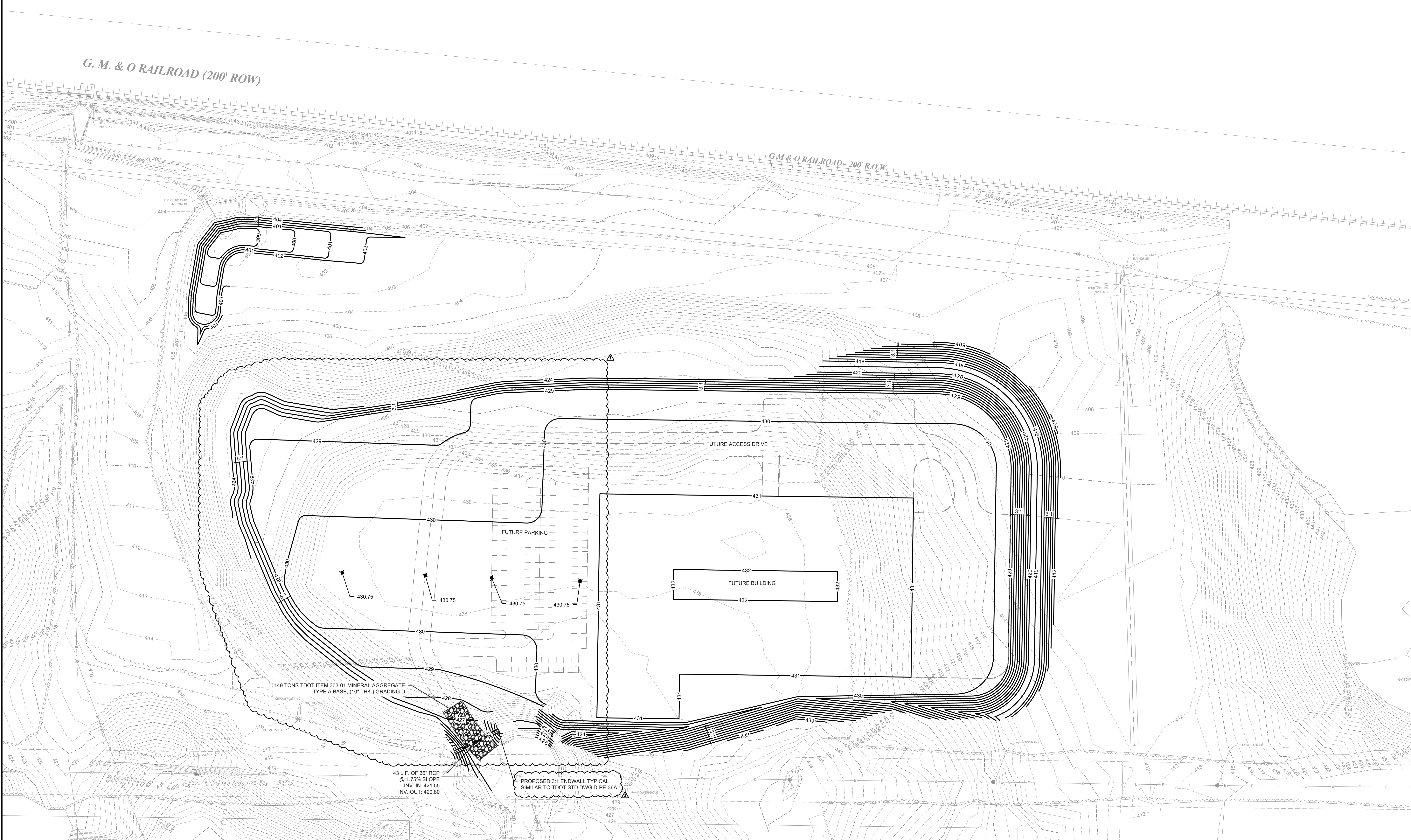

**TLM Associates, Inc. General Construction Notes**

- All existing utilities shown, both above and below ground, are approximately located and are not necessarily all that exist. The contractor shall field verify utilities prior to construction by discussing with owner and local utility provider. Per Tennessee State Law, the contractor shall notify Tennessee One Call (811 or 1-800-351-1111) at least 72 hours prior to digging.
- The contractor shall be responsible for providing all line, grade and stakeout for the construction of the project. The engineer shall provide a bench mark and horizontal control should they not be stipulated on the drawings.
- The contractor shall insure that all documents including Notice of Intent (NOI), Storm Water Pollution Prevention Plan (SWPPP), and permit fees necessary for a NPDES Permit for Storm Water Discharge have been filed with the TN Dept. of Environment and Conservation (TDEC) and a Notice of Coverage (NOC) received prior to the start of construction.
- All contractors shall be aware that there may be other contractors on site working on other portions of the project. Contractors shall coordinate and cooperate with each other to avoid conflict and damage to each others work.
- The contractor shall confirm elevations and proposed locations of improvements prior to construction and report any discrepancies to the Engineer.
- Items of work referred to using the abbreviations "TDOT" shall be constructed and tested in accordance with the Tennessee Department of Transportation Standard Specifications for Road and Bridge Construction, dated January 1, 2021 or latest edition, along with applicable "Standard Drawings" and "Special Provisions".
- Prior to placing any granular base material, the area shall be proof-rolled with a truck loaded to 30 tons. Unsuitable material shall be removed, replaced with suitable material and compacted to a minimum of 95% standard proctor density. The completed sub-grade of the future building pad, drives, parking areas and the granular base shall be also be proof-rolled prior to acceptance.
- All earthwork fill areas shall be constructed using 8" maximum compacted lifts achieving 95% standard proctor density. For fills of more than six (6) feet, compaction shall be 100% standard proctor density. The top one foot of all sub-grades which will be under improvements, including paving, shall be compacted to 100% standard proctor density.
- The following shall be applied to storm drainage piping and installation:  
a. RCP - abbreviation for Reinforced Concrete Pipe, Class III u.s.a., designed in accordance with ASTM C-76. Joining shall be with O-ring gaskets. Install 6" sand or gravel bedding on solid foundation. Backfill to the spring line with clean sand or gravel (with greater than 50% sand or gravel) and then complete backfill with quality select excavated material. Backfill shall be placed in 8" maximum loose lifts and compacted to a minimum of 90% standard proctor density.
- Adjust valve boxes, meter boxes, manhole tops, catch basins and fire hydrants, etc. to match the finish grade. Where catch basins are identified on the plans using TDOT specification numbers, pre-manufactured catch basins which meet or exceed the minimum area of steel may be substituted. All such substitutions shall be certified by a Tennessee licensed engineer as meeting or exceeding the specified requirements.

**NOTE TO CONTRACTOR:**  
1. CONTRACTOR TO PROVIDE AS-BUILT SURVEY FROM 3RD PARTY LICENSED SURVEYOR UPON COMPLETION OF GRADING WORK.  
2. SOIL FROM POND WILL BE STORED ON SITE WITH SILT FENCE PROTECTION AND WILL BE USED TO RESTORE ORIGINAL POND CONTOURS WHEN SITE WORK IS COMPLETE.

**LEGEND:**

|  |                        |
|--|------------------------|
|  | EXISTING CONTOUR       |
|  | PROPOSED CONTOUR       |
|  | PROPOSED DRAINAGE PIPE |

**-NOTICE TO CONTRACTORS-**  
ALL EXISTING UTILITIES SHOWN BOTH ABOVE AND BELOW GROUND ARE APPROXIMATE AND ARE NOT NECESSARILY ALL THAT EXIST. THE DETERMINATION OF THE EXISTENCE AND LOCATION OF ALL UTILITIES SHALL BE THE RESPONSIBILITY OF THE CONTRACTOR

