

1/9/2024 8:58:48 AM
 P:\StandDraw\DESIGN STANDARDS\Standards Drawings\Standard Roadway Drawings - CURRENT\In Progress\10-108.00 Design - Traffic Control IP\108.01 Pavements Markings IP\T-M-19-20231219.dgn

REV. 07-07-2023: REPLACED THE DOTTED WHITE LINES WITH STOP BARS AT THE INTERSECTION.

REV. 01-09-2024: ADDED YIELD LINES AT THE INTERSECTION.

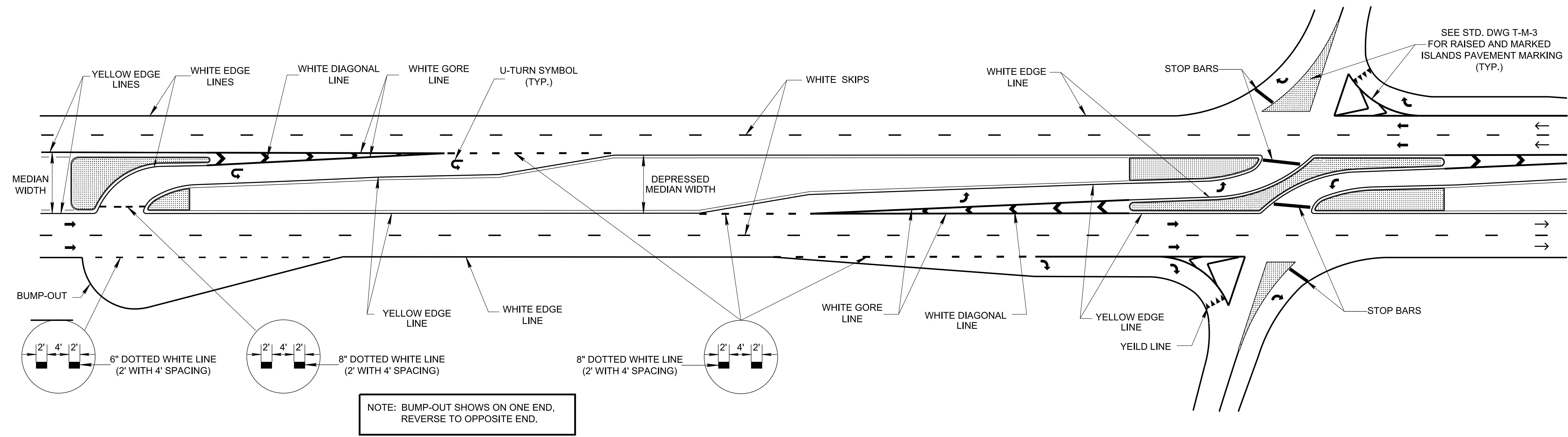

PLAN VIEW FOR J-TURN AND RESTRICTED CROSSING INTERSECTIONS

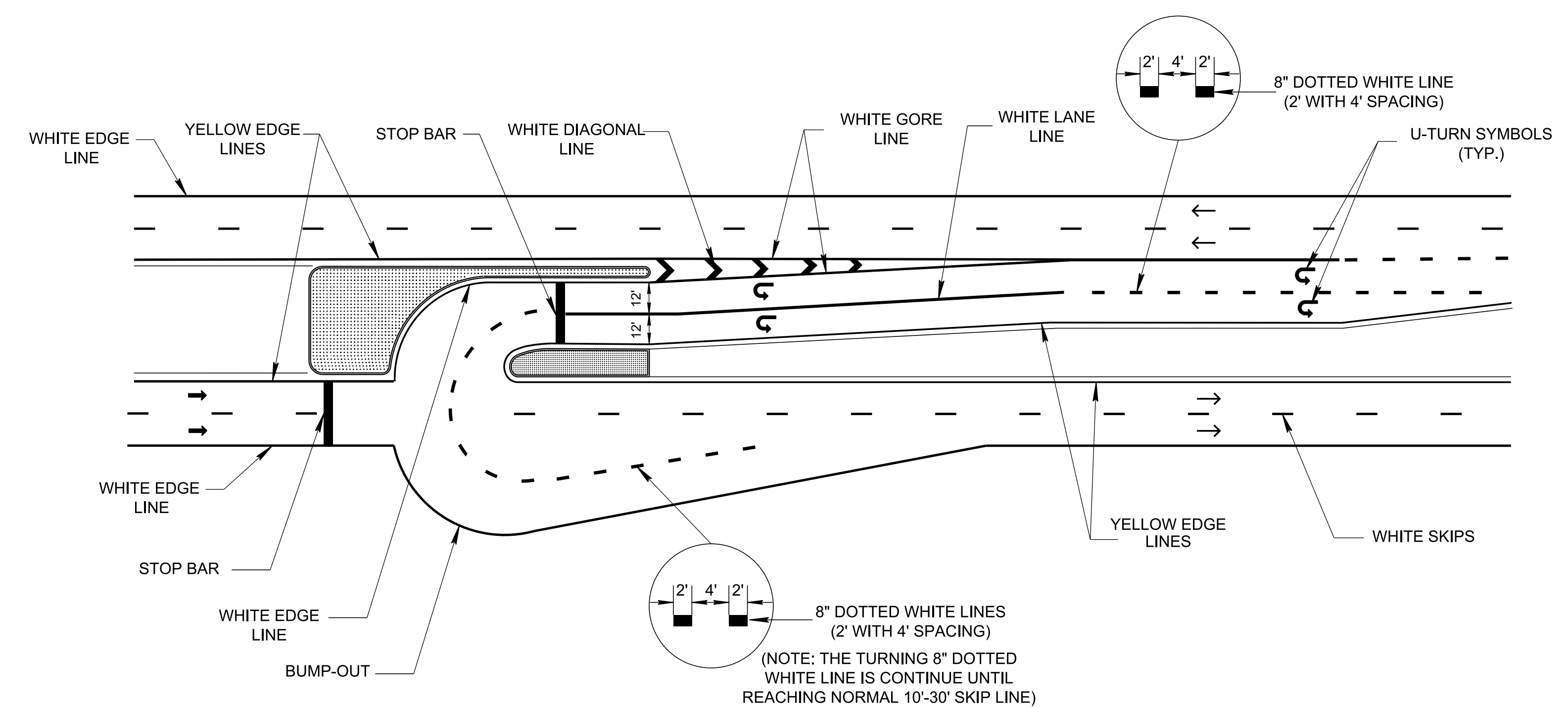

PLAN VIEW FOR SIGNALIZED J-TURN (DUAL U-TURN) INTERSECTION

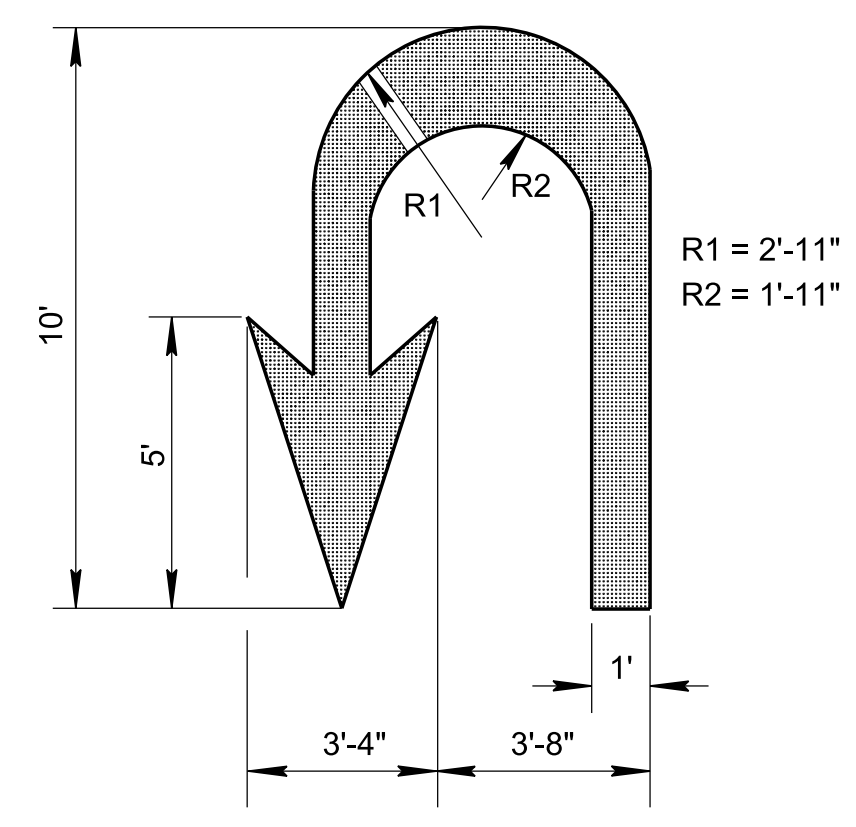

U-TURN LEFT-USE ARROW

| LEGEND | |
|--------|--------------------------------------|
| | CONCRETE ISLANDS AND/OR SLOPING CURB |
| | PAVEMENT MARKING SYMBOLS |
| | DIRECTION OF TRAFFIC |

| GENERAL NOTES | |
|---------------|---|
| (A) | SEE STANDARD DRAWING RP-DHO-2 FOR MEDIAN OPENING DETAILS AND T-S-26 FOR SIGNING DETAILS FOR RESTRICTED CROSSING AND J-TURN INTERSECTIONS. |
| (B) | SEE STANDARD DRAWING T-M-3 AND T-M-4 FOR CHANNELIZATION MARKING AND INTERSECTION MARKING DETAILS. |
| (C) | PAVEMENT MARKERS ARE REQUIRED ONLY WHEN SPECIFIED IN THE PLANS. |

STATE OF TENNESSEE
 STANDARD DRAWING
DEPARTMENT OF TRANSPORTATION

PAVEMENT MARKING
DETAILS FOR
RESTRICTED
CROSSING & J-TURN
INTERSECTIONS

09-22-2022 T-M-19

NOT TO SCALE