

PLAN VIEW
(BOTTOM MAT OF STEEL)

PLAN VIEW
(TOP MAT OF STEEL)

NOTE: BARS A700E AND BARS A700 SHALL BE TWO SPLICED BARS WHEN BOX WIDTH (BW) IS GREATER THAN 60'-4". SEE STD-17-3 FOR SPLICE LENGTHS.

CONST. NO.			
PROJECT NO.	YEAR	SHEET NO.	
	2010		
REVISIONS			
NO.	DATE	BY	BRIEF DESCRIPTION

EDGE BEAM ESTIMATED QUANTITIES

QUANTITIES PER FOOT	
BAR	REINFORCING LBS.
A700E	28.62
A700	28.62

NOTE: SKEW ANGLES LESS THAN 45° REQUIRE SPECIAL DESIGN.

NOTES

SEE STD-17-3 FOR STAGE CONSTRUCTION NOTES.

GENERAL NOTES

NOTE: QUANTITIES WILL BE BASED ON PLANS DIMENSIONS, AS SHOWN ON THE FOLLOWING DRAWINGS: ROADWAY CULVERT SHEETS, THE CONCRETE BOX OR SLAB BRIDGE DRAWINGS DESIGNED FOR A SPECIFIC LOCATION, OR THE STANDARD BOX OR SLAB BRIDGE DRAWINGS.

NOTE: ALL BARS "A" ARE STRAIGHT BARS.

STATE OF TENNESSEE
DEPARTMENT OF TRANSPORTATION

STAGE CONSTRUCTION
JOINT DETAIL
(FILL ABOVE TOP OF SLAB NOT GREATER THAN 3'-6")

STANDARD REINFORCED
CONCRETE BRIDGE
BOX OR SLAB TYPE

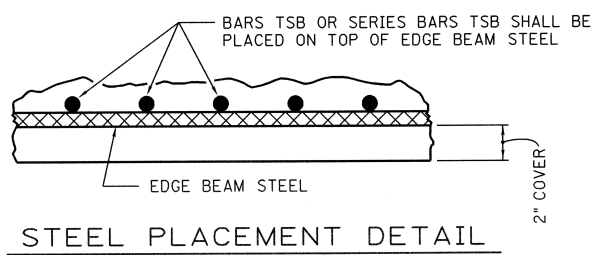

STEEL PLACEMENT DETAIL

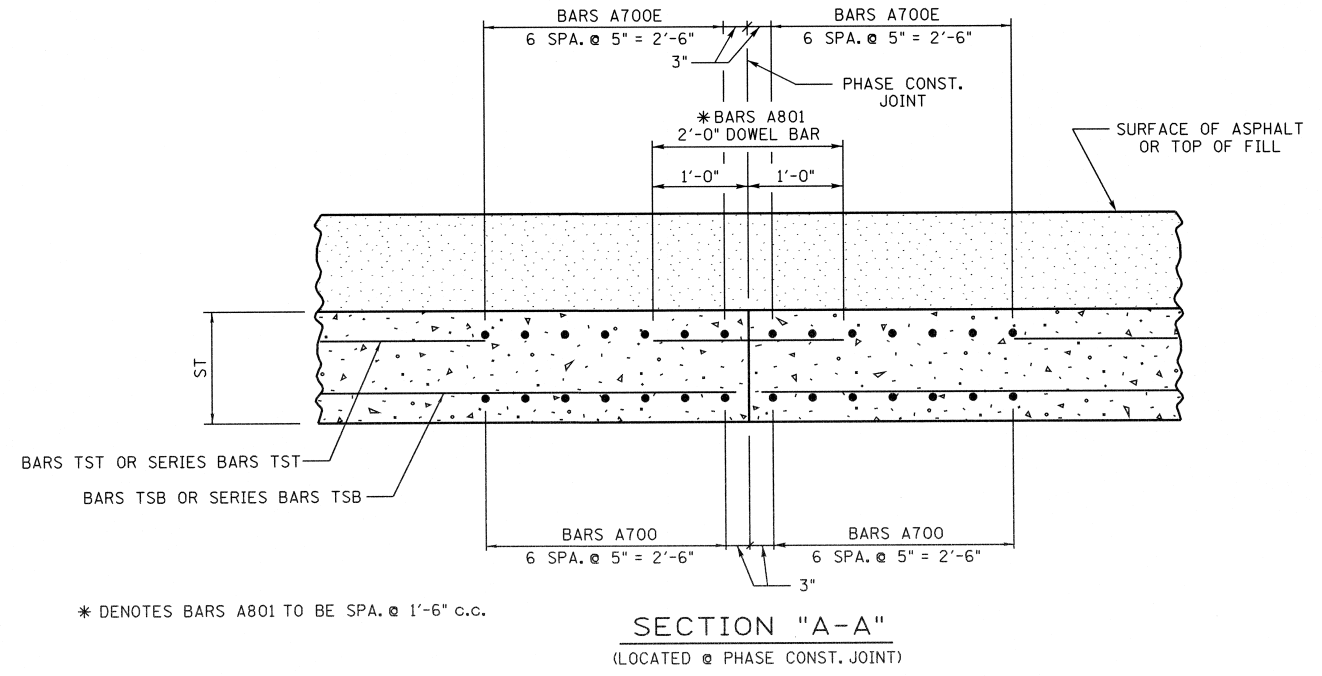

SECTION "A-A"
(LOCATED @ PHASE CONST. JOINT)

* DENOTES BARS A801 TO BE SPA. @ 1'-6" C.C.

DESIGNED BY CMH / MAH DATE 12-09
DRAWN BY DIANE BUSH DATE 04-10
SUPERVISED BY RLH / JWP / MAH DATE 12-09
CHECKED BY DATE

CORRECT *Edward P. Wasserman* 2010
ENGINEER OF STRUCTURES