

**LONGITUDINAL CONSTRUCTION JOINTS**

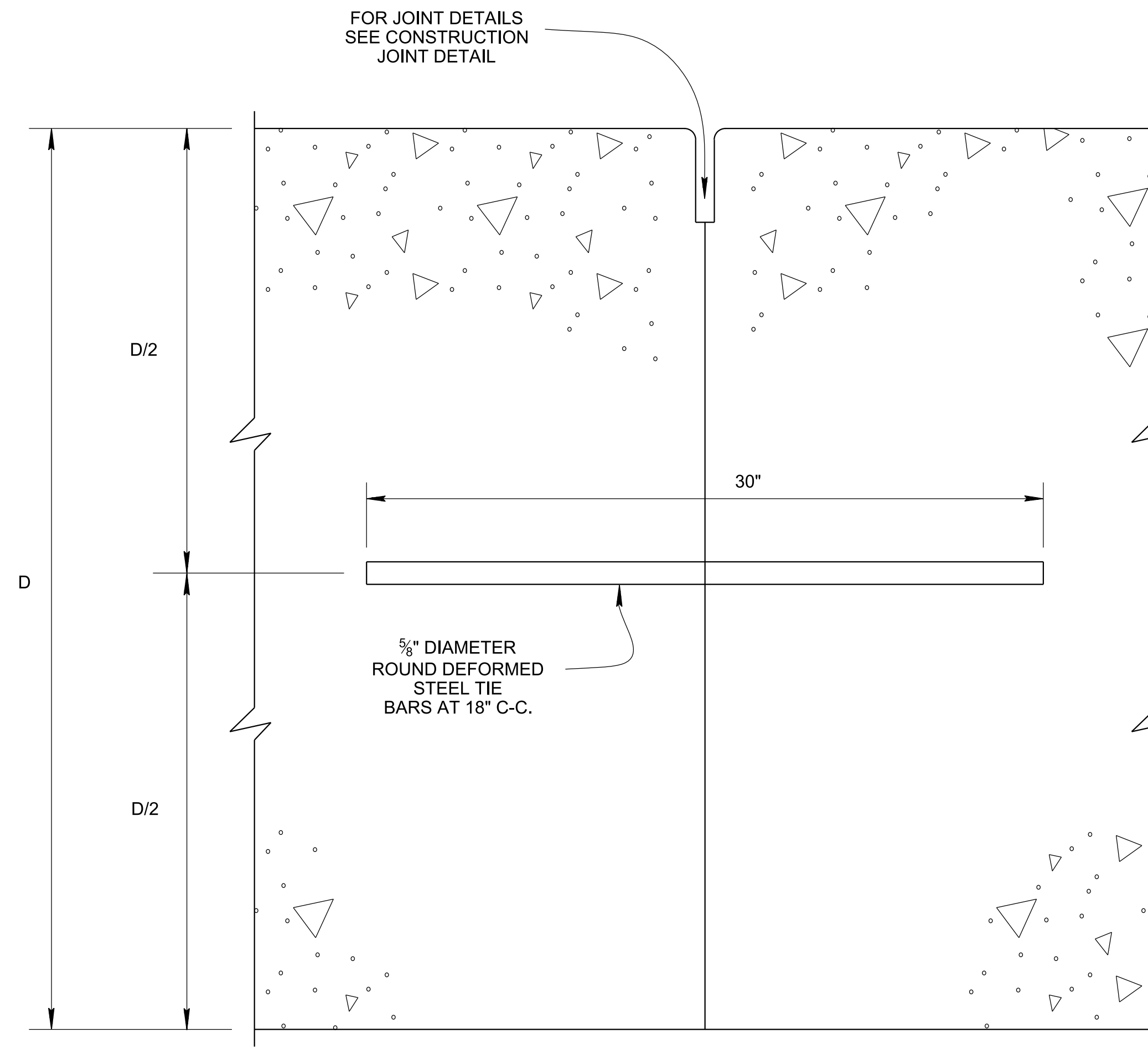

**TIE BAR DETAIL FOR LONGITUDINAL CONSTRUCTION JOINTS**

FOR JOINT LOCATIONS SEE DRAWINGS RP-J-1, RP-J-3, RP-J-5 AND RP-J-7.

REV. 10-26-00: REDREW AND RENAMED SHEET. ELIMINATED USE OF CHANNEL KEYS AND ALL RELATED DETAILS. ELIMINATED DETAILS FOR HOOK BOLT JOINT.

REV. 1-19-02: ADDED NEW GENERAL NOTE (B). REDESIGNATED ALL SUBSEQUENT GENERAL NOTES.

REV. 05-01-20: REDREW SHEET.

CROSS-REFERENCE DRAWINGS FOR THIS SHEET: RP-J-1, RP-J-3, RP-J-5, RP-J-7, AND RP-J-9.

APPROVED BY FHWA (ALL OTHERS APPROVED BY TDOT)

STATE OF TENNESSEE  
 STANDARD DRAWING  
 DEPARTMENT OF TRANSPORTATION

LONGITUDINAL CONTRACTION AND CONSTRUCTION JOINTS

07-29-1998 RP-J-15

- GENERAL NOTES**
- (A) LONGITUDINAL CONTRACTION AND/OR CONSTRUCTION JOINTS WITH TIE BARS SHALL BE REQUIRED.
  - (B) LONGITUDINAL CONTRACTION AND/OR CONSTRUCTION JOINTS IN THE PORTLAND CEMENT CONCRETE SHOULDERS SHALL BE OF THE SAME TYPE, MATERIAL AND SPACING AS THE CORRESPONDING JOINTS IN THE PORTLAND CEMENT CONCRETE TRAFFIC LANES. (SEE SUBSECTION 501.23 (b) OF THE STANDARD SPECIFICATIONS.) SEE STANDARD DRAWINGS RP-CS-1 AND RP-CS-2 FOR FURTHER DETAILS.
  - (C) TIE BARS SHALL BE 2'-6" LONG AND SPACED AT 1'-6" CENTER-TO-CENTER.
  - (D) TIE BARS SHALL BE FIVE EIGHTS-INCH DIAMETER ROUND DEFORMED STEEL BARS AND CONFORM TO ASTM A615-GRADE 40 SPECIFICATIONS.
  - (E) TIE BARS SHALL NOT BE PLACED WITHIN 15" OF TRANSVERSE CONTRACTION OR CONSTRUCTION JOINTS AND EXPANSION JOINTS.