

10/28/2021 11:43:12 AM
 P:\StandDraw\DESIGN STANDARDS\Standards Library\Standard Roadway Drawings - CURRENT\In Progress\10-106.00 Safety Design and Guardrails IP\106.09 Concrete Median Barriers IP\SSMB1A 2

REV. 10-29-2021: DELINEATOR MOUNTING
 DETAIL AND DELINEATOR NOTES WERE
 REMOVED. ADDED GENERAL NOTE (L) FOR
 DELINEATOR MOUNTING DETAILS
 REFERENCE STD. DWG. AND PLAN VIEW.

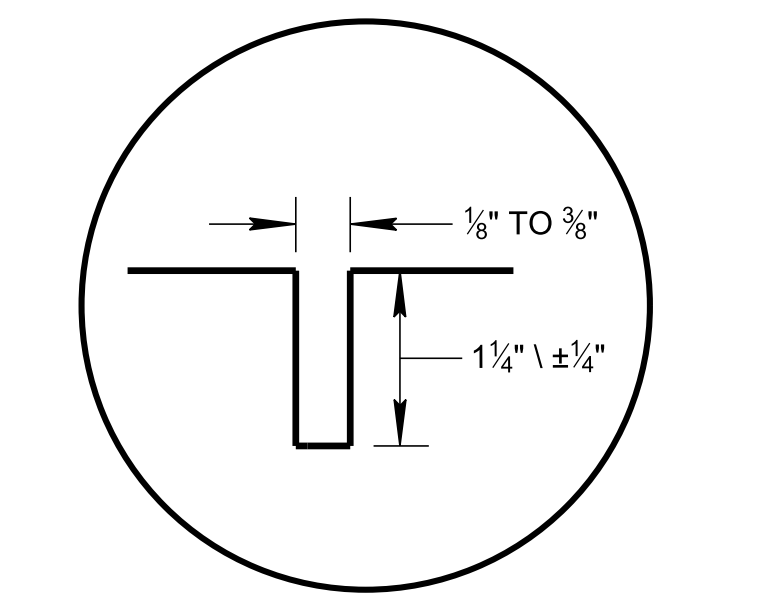

CONTRACTION JOINT DETAIL

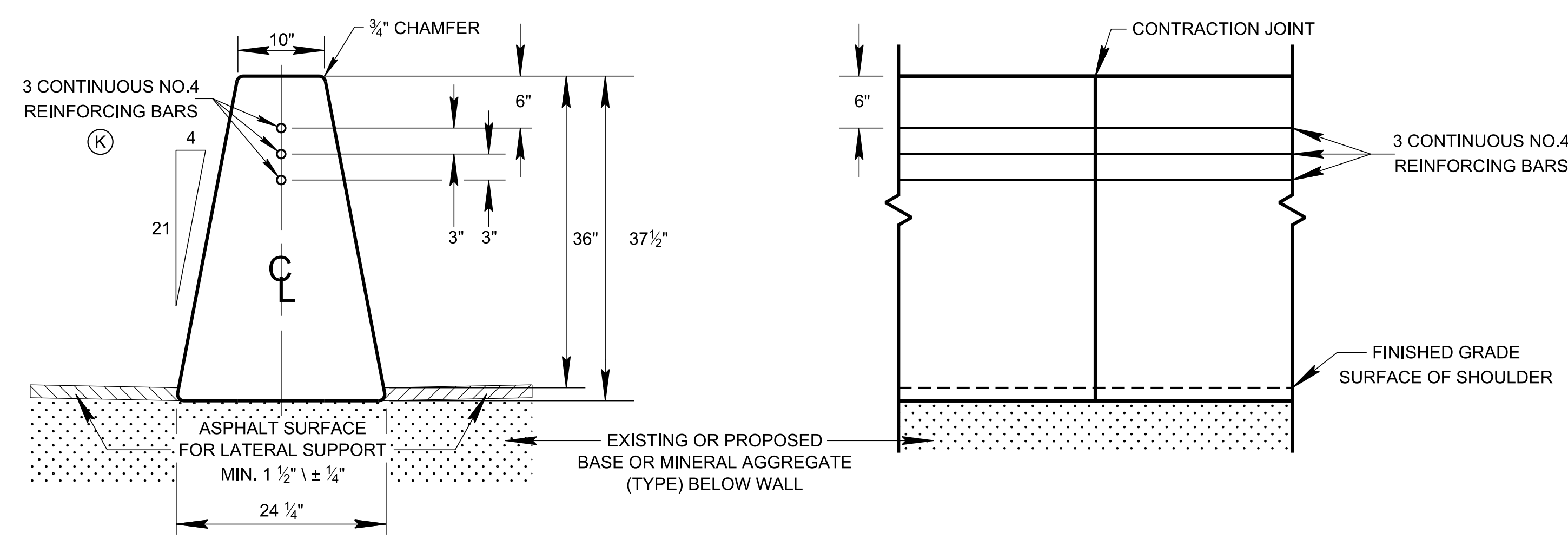
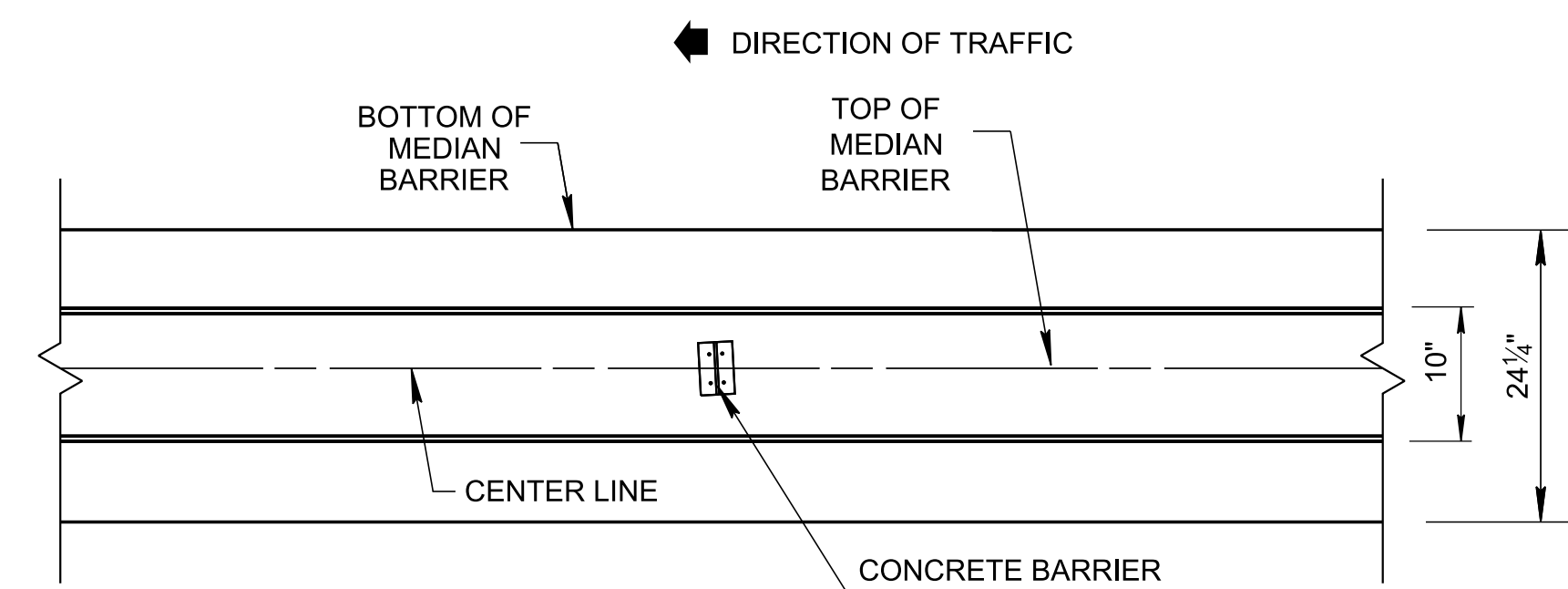

PLAN VIEW

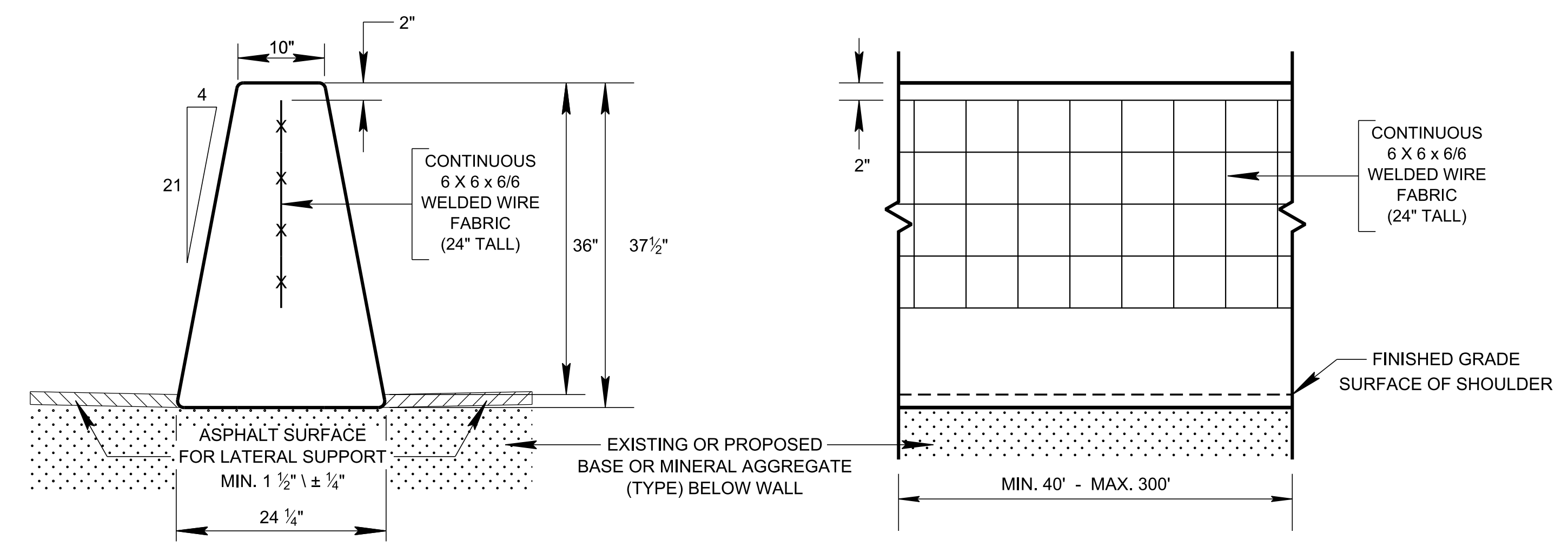

ELEVATION VIEW

SECTION VIEW

36" HEIGHT WALL WITH ALTERNATE REINFORCING

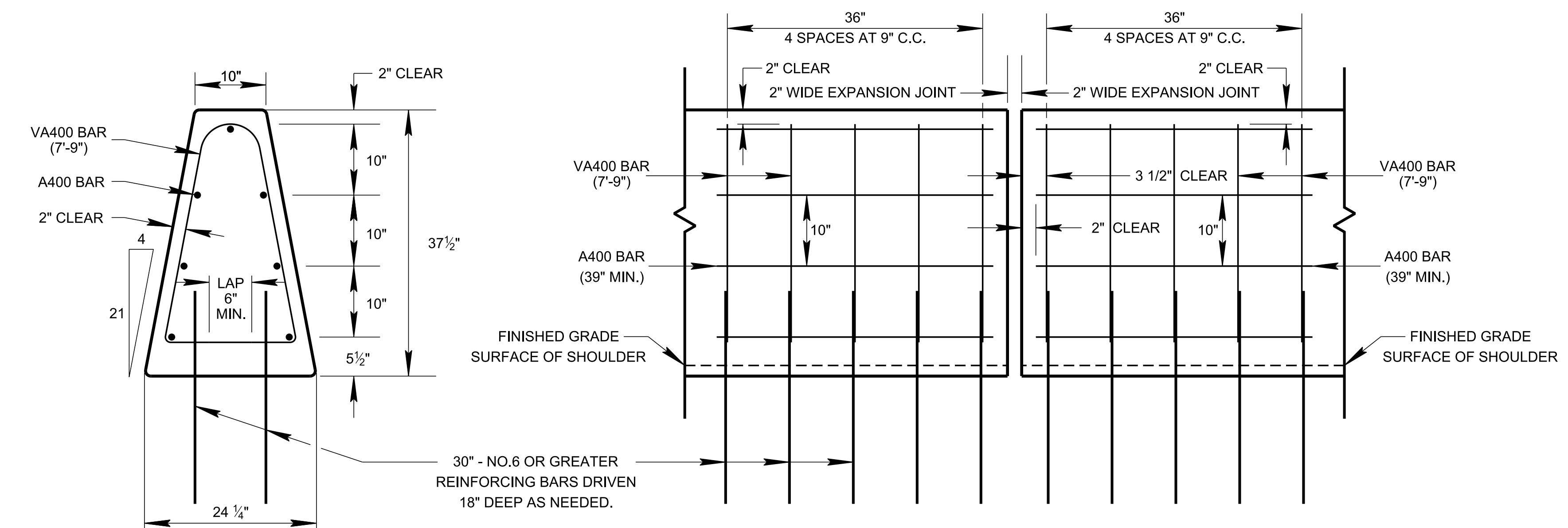

ELEVATION VIEW

SECTION VIEW

DETAILS OF ADDITIONAL REINFORCING AT THE WALL ENDS OR AT EXPANSION JOINT

GENERAL NOTES

- (A) CONCRETE BARRIER WALL SHALL BE CONSTRUCTED IN ACCORDANCE WITH STANDARD SPECIFICATIONS FOR ROAD AND BRIDGE CONSTRUCTION, SECTION 711 AND/OR CURRENT SPECIAL PROVISIONS.
- (B) IF SAWED CONTRACTION JOINTS ARE USED, THE JOINTS MUST BE SAWED WITHIN FOUR (4) HOURS AFTER THE CONCRETE IS PLACED.
- (C) THE CONTRACTION JOINTS ARE TO BE SPACED AT 20 TO 25 FOOT INTERVALS WHEN CONSTRUCTED ON ASPHALT PAVEMENT. WHEN THE CONCRETE BARRIER WALL IS ATTACHED TO CONCRETE PAVEMENT THE CONTRACTION JOINTS WILL CORRESPOND TO THE JOINTS IN THE CONCRETE PAVEMENT. THE COST OF MATERIAL AND LABOR FOR THE JOINT INSTALLATION SHALL BE INCLUDED IN THE BID PRICE FOR CONCRETE MEDIAN BARRIER.
- (D) THE CONCRETE BARRIER WALL SHALL BE GIVEN AN APPLIED TEXTURE FINISH. THE COLOR OF THE FINISH SHALL BE WHITE, FEDERAL SPECIFICATION NO. 37886. THE COST OF MATERIALS AND LABOR FOR THE TEXTURE FINISH SHALL BE INCLUDED IN THE BID PRICE FOR CONCRETE MEDIAN BARRIER.
- (E) THE TWO (2) INCH OPEN EXPANSION JOINTS SHALL BE PLACED AT A MAXIMUM SPACING NOT TO EXCEED 300 FEET. IF FIXED OBJECTS SUCH AS BRIDGE PIERS, BRIDGE ENDS, OVERHEAD SIGN SUPPORTS, OR OTHER FEATURES PROJECTING THROUGH, INTO OR AGAINST THE BARRIER EXIST THAT REQUIRE TWO INCH EXPANSION JOINTS, THEN THE DISTANCE BETWEEN THE EXPANSION JOINTS IS TO BE REDUCED IN ORDER TO ALLOW AN EQUAL DISTANCE BETWEEN JOINTS THAT IS LESS THAN 300 FEET. ALL ADDITIONAL STEEL REQUIRED AT EXPANSION JOINTS IS TO BE EPOXY COATED REINFORCING STEEL. THE COST OF MATERIAL AND LABOR FOR THE JOINT INSTALLATION SHALL BE INCLUDED IN THE BID PRICE FOR CONCRETE MEDIAN BARRIER.
- (F) THE TOP AND END EDGES OF THE CONCRETE BARRIER WILL HAVE A 3/4" TO 1" CHAMFER. IF BARRIER WALL IS SLIP-FORMED, ROUNDED EDGES WITH A 1" RADIUS MAY BE USED INSTEAD OF THE CHAMFER.
- (G) BAR SPLICES FOR ROADWAY BARRIER SHALL BE A MINIMUM OF 24 TIMES THE NOMINAL DIAMETER OF THE BAR.
- (H) ANY METHOD DEvised BY THE CONTRACTOR AND APPROVED BY THE ENGINEER THAT WILL ASSURE THE LONGITUDINAL ROADWAY REINFORCING STEEL WILL BE FIXED AGAINST MOVEMENT AND POSITIONED ± 1/2 INCH AS DIMENSIONED WHEN TIED TO THE TRANSVERSE ROADWAY REINFORCING STEEL WILL BE SATISFACTORY.
- (I) PAYMENT WILL BE MADE UNDER ITEM NO. 711-05.69, 36" SINGLE SLOPE CONCRETE BARRIER WALL, PER LINEAR FOOT.
- (J) MIN. SAFETY PERFORMANCE OF 36" SINGLE SLOPE WALL HAS BEEN EVALUATED UNDER MASH TL-4 AND DOCUMENTED ON TEST REPORT TTI: 9-1002-5, "DETERMINATION OF MINIMUM HEIGHT AND LATERAL DESIGN LOAD FOR MASH TEST LEVEL 4 BRIDGE RAILS".
- (K) THE CONTRACTOR MAY ELECT TO USE 3 CONTINUOUS ROPE CABLES INSTEAD OF THE 3 NO. 4 REINFORCING BARS. EACH CABLE MUST BE 3/4 INCH (MINIMUM) DIAMETER, ZINC-COATED (GALVANIZED) WIRE ROPE MANUFACTURED IN ACCORDANCE WITH AASHTO M 30.
- (L) REFER TO STANDARD DRAWING T-M-18A FOR MEDIAN BARRIER DELINEATOR MOUNTING DETAILS AND NOTES. THE COST OF FURNISHING AND INSTALLING MEDIAN BARRIER DELINEATORS SHALL BE INCLUDED WITH THE BID PRICE FOR CONCRETE MEDIAN BARRIERS.

STATE OF TENNESSEE
 STANDARD
 DRAWING
 DEPARTMENT OF TRANSPORTATION

36"
 SINGLE SLOPE
 CONCRETE
 BARRIER
 WALL