

Table titled '3 @ 16 x 13 REINFORCED CONCRETE SLAB BRIDGE'. It lists various dimensions and reinforcement details for different fill heights and moment break conditions.

Table titled '3 @ 16 x 14 REINFORCED CONCRETE SLAB BRIDGE'. It lists various dimensions and reinforcement details for different fill heights and moment break conditions.

Table titled '3 @ 16 x 15 REINFORCED CONCRETE SLAB BRIDGE'. It lists various dimensions and reinforcement details for different fill heights and moment break conditions.

Table titled '3 @ 16 x 16 REINFORCED CONCRETE SLAB BRIDGE'. It lists various dimensions and reinforcement details for different fill heights and moment break conditions.

Note: Maximum fill height is measured from the bottom of the top slab. To obtain the total fill height from the flow line, add the height of the box.
Note: When height of fill above the top slab is less than 1 foot, the top mat of reinforcing in the top slab shall be constructed with 2-1/2 inches of concrete cover.

The following bar information applies to all fill cases in the tables above:
Bars LNT Size = 4 Spacing = 12 in.
Bars LND Size = 5 Spacing = 12 in.
Bars WS Size = 8 Length = 5.00 ft. Spacing = 12 in.
Bars WF Size = 8 Length = 6.00 ft. Spacing = 12 in.
Bars WF Size = 4 No. = 2 Spacing = 12 in.
Bars EWF Size = 4 No. = 2 Spacing = 12 in.

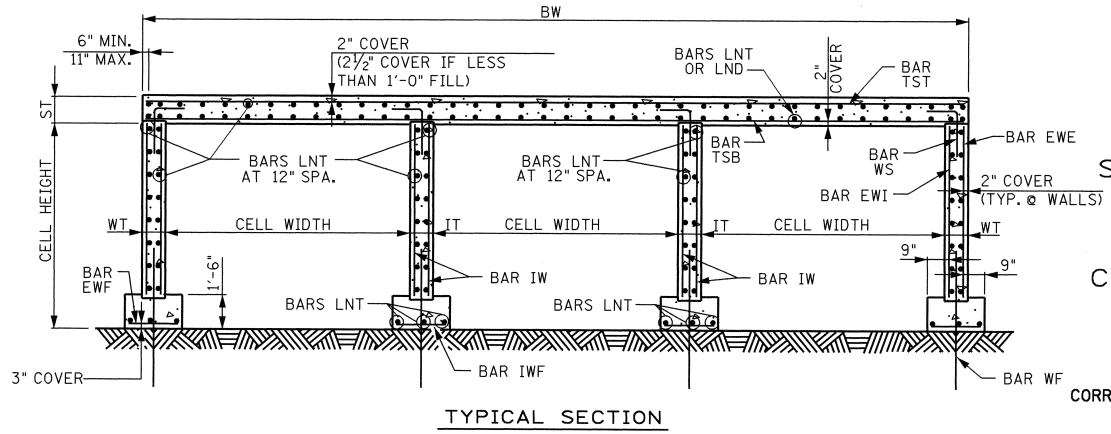

NOTE: FOR DESCRIPTIONS OF BOX DIMENSIONS AND REINFORCING BAR DESIGNATIONS SEE STANDARD DRAWING NO. STD-17-5.

STATE OF TENNESSEE
DEPARTMENT OF TRANSPORTATION
STANDARD REINFORCED CONCRETE
SLAB BRIDGE
INTERIOR SECTION
SPANS: 3 BARRELS AT 16'-0"
CLEAR HEIGHTS 13'-0" THRU 16'-0"
0' THRU 60' FILL
2010

CORRECT Edward P. Wasserman
ENGINEER OF STRUCTURES

DESIGNED BY RLL/ALP DATE 12-09
DRAWN BY KEVIN MARTINKO DATE 1-10
SUPERVISED BY EPW/RLC DATE 12-09
CHECKED BY RLL/ALP DATE 2-10

CONST. NO. PROJECT NO. YEAR SHEET NO. 2010
REVISIONS NO. DATE BY BRIEF DESCRIPTION

Vertical text on the left edge of the page, likely a file path or drawing identifier.